

Graduation Project'21 Fall  
ITU Faculty of Architecture  
Department of  
Landscape Architecture

# Landscape

# Demmo

rule

\*

# kratos

\*

# demos

the people

# cracy

# :Taksim

**Core Jury Members**  
Prof. Hayriye ESBAH TUNÇAY, Ph.D. -  
Prof. Gulsen Aytac, Ph.D.  
Assist. Prof. Melih Bozkurt, Ph.D.

**Guest Jury Members**  
Assoc. Prof. Olgü ÇAĞIRKAN, Ph.D.

MSc. Arzu KULFAK  
Zuhra Kol

Carles Zardo Sanz

**Research Assistants**  
Nergis Asar - Gizem Alıncı



**ITU  
LANDSCAPE ARCHITECTURE  
DEPARTMENT**

**STUDIO REPORTS:**

**LANDSCAPE  
GRADUATION PROJECT**

**LANDSCAPE DEMOCRACY: TAKSIM**

**2020-2021  
FALL SEMESTER**

# PEM 409E LANDSCAPE GRADUATION PROJECT

LANDSCAPE DEMOCRACY:

TAKSIM

Istanbul Technical University,  
Faculty of Architecture,  
Department of Landscape  
Architecture, Taskısla Campus

Phone: +90 (212) 2931300  
ext.2808 Fax: +90 (212) 2514895  
E-mail : peyzajmim@itu.edu.tr

#### Editors

Prof.Hayriye Eşbah Tunçay, PhD.  
Prof. Gülşen Aytaç, PhD.  
Assist. Prof. Melih Bozkurt, PhD.  
Nergis Aşar  
Gizem Aluçlu

#### Graphic Design:

Nergis Aşar  
Gizem Aluçlu

#### Core jury Members:

Prof.Hayriye Eşbah Tunçay, PhD.  
Prof. Gülşen Aytaç, PhD.  
Assist. Prof. Melih Bozkurt, PhD.

#### Guest Jury Members:

Assoc. Prof. Olgu Çalışkan, PhD.  
MSc. Arzu Kutkam  
MSc. Zühal Kol  
Carlos Zarco Sanz

#### Research Assistants

Nergis Aşar  
Gizem Aluçlu

# LANDSCAPE DEMOCRACY: TAKSİM

\*demos \*kratos

"Landscape contextualizes democracy. Public space and parks represent the locus for the daily. Everyday performance of democracy; these are places where democracy could be learned and practiced in the long run. As the landscape is the quintessential cultural construct, it becomes the ideal vessel for the values and beliefs of residents. It is both the outcome of social processes and a structuring element for new processes of social construction" ( Makzhoumi, 2019).

Taksim is a unique platform whose value as the landscape is difficult to calculate in spatial, political, and aesthetic terms. Taksim Square and Gezi Park coexist in the middle of a very dense urban matrix. Even though their physical properties are distinct, this duality constructs an interdependence of functions and complexity of discourses and actions. The richness of relationships between nature and artifice and the plurality of uses in such a vast urban space makes this landscape the most vibrant area in Istanbul.

The purpose of this project is to elaborate on how Taksim Square and Gezi Park go beyond being a "social and political green" and adapt well to changing social needs over time. More specifically, the project seeks design alternatives that will work as incubators of cultural co-habitation and self-organization. It requires spatial and infrastructural improvement proposals to trigger a more comprehensive social and physical change in the area. Finally, the project expects the students to develop a democratic landscape change process facilitated by a sustainable landscape and urban design. Even though the emphasis is on landscape democracy, the students should also question public space in the Covid-19 outbreak days when social distancing has become daily life. Students should respond for a post-Covid-19 era.



**TAKSİM ENCOUNTERS**  
MEHMET BULUT

Taksim Encounters, with the process-based design philosophy, pushes the boundaries of landscape design concept through the pursuit of a new approach of open publicity in a such urban environment like Taksim. Having the aim of integration of intangible and tangible design interventions,

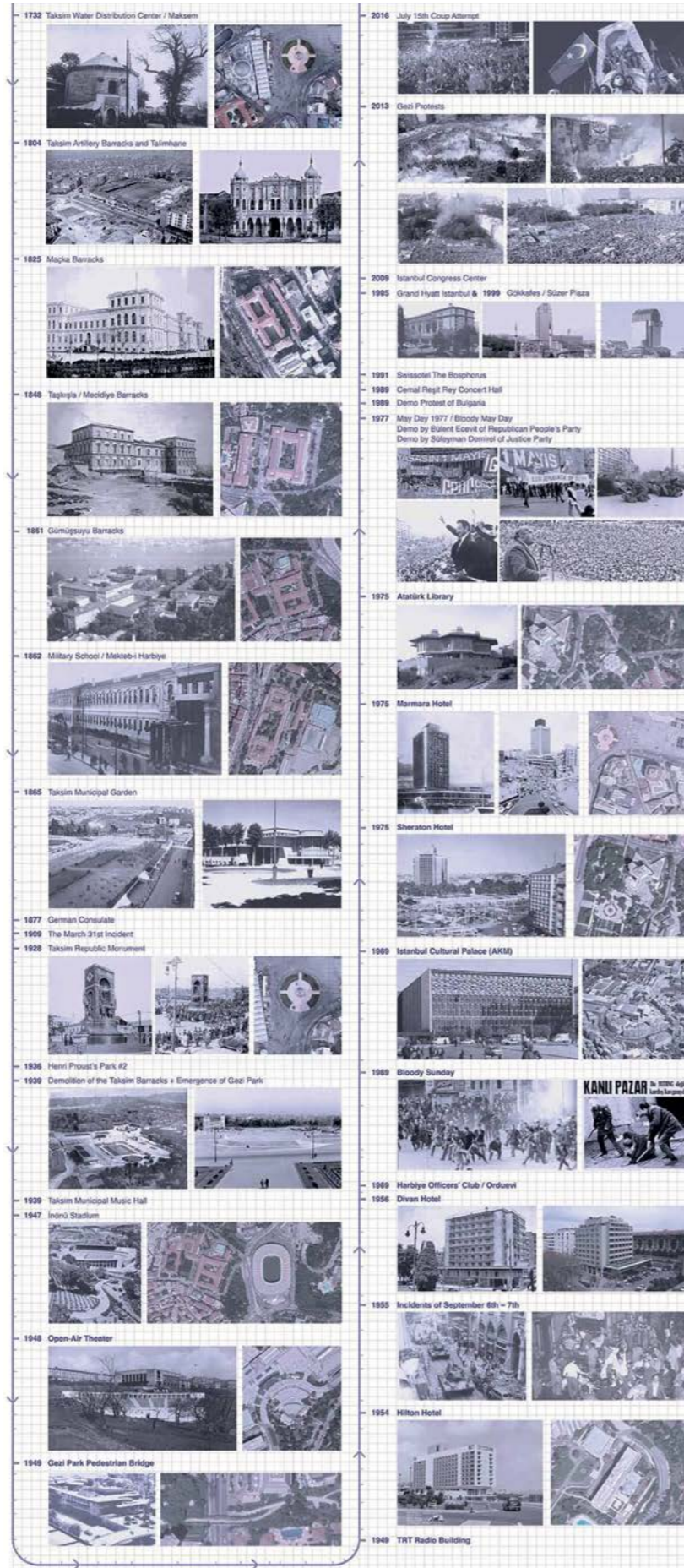

Taksim Encounters seeks for the coupling of digital and physical conditions on the urban space to achieve a much more consolidated public use of the space. Further, this integrity generates an engaging democratic frame for the sake of the urban use to intensify the historical and socio-cultural context of the Taksim Square, Gezi Park and the close vicinity in a whole. Also, the overlapping layers of this landscape design approach, associates the ecological, physical and contextual components of the area. Having benefit from the inter-related urban pieces, Cumhuriyet Street, Gezi Park, Taksim Municipal Garden, Republic Square, Maksem, Underground Level and Atatürk Cultural Center have been treated as the common ingredients of the whole urban environment; have been combined under the roof of urban democracy and coupled with the open use design approach -LocI- to extend the conceptuality of the urban design and landscape system.

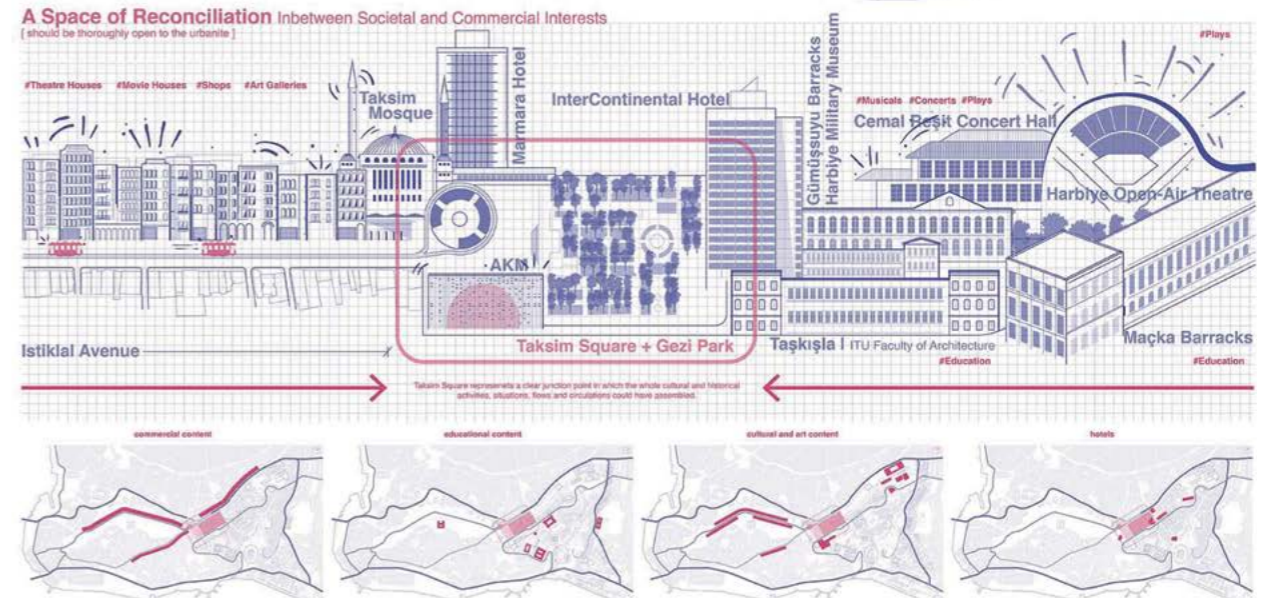
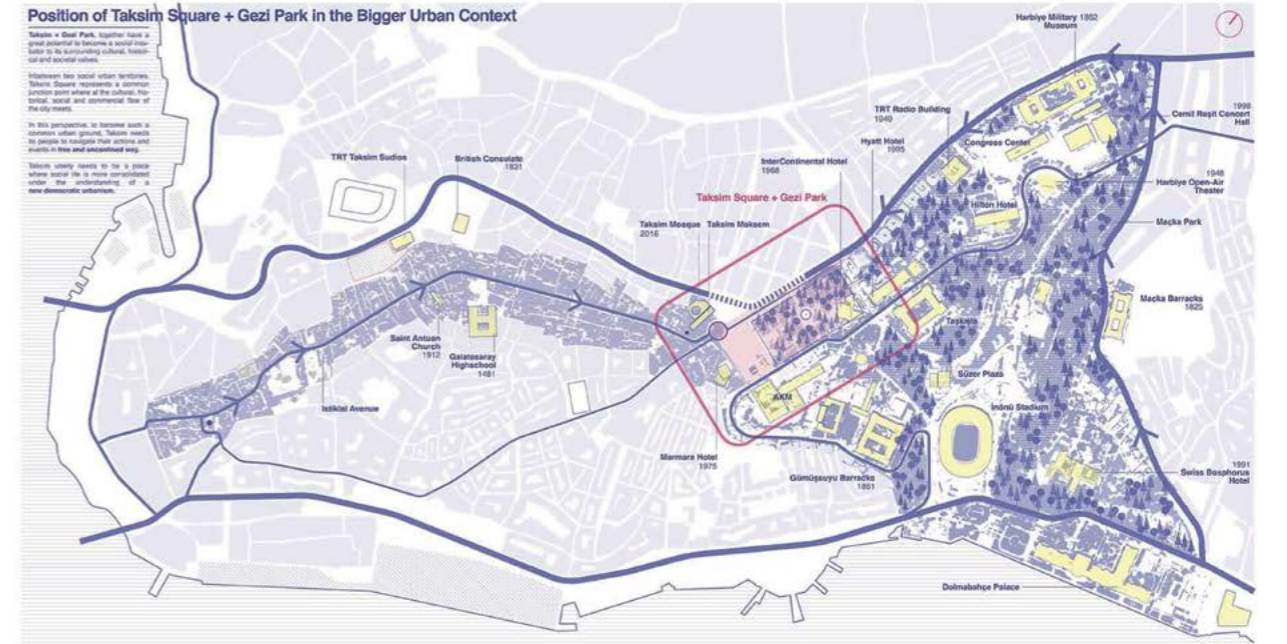



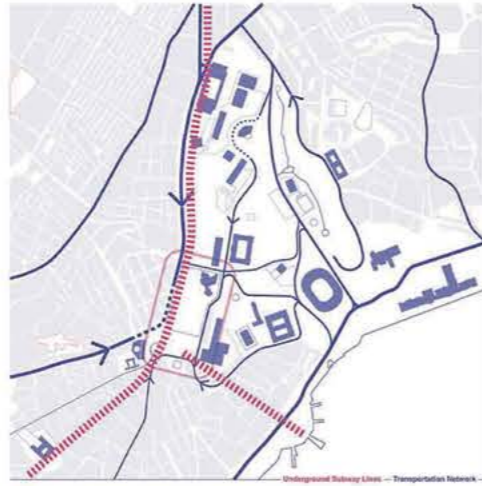
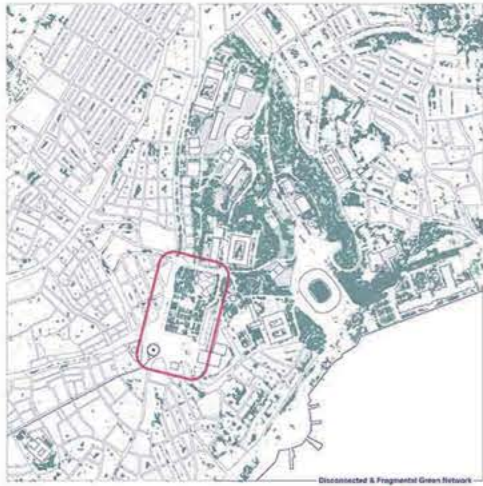

**democracy as a social device for an engaging urban life**

'Democracy is based on the freely-expressed will of the people to determine their own political, economic, social and cultural systems and their full participation in all aspects of their lives.' the Vienna Declaration on Human Rights states. As the concept of democracy addresses the right of equal self-determination of peoples, and respect for individual collective human rights and fundamental freedoms are the essential bases when it comes to the urban rights and public consensus. And, in this sense, democracy is the best safeguard of freedom of expression, tolerance of all groups of society, and equality of opportunity for each person.

Regarding these urban approaches, in the particular design case, Taksim has been taken into consideration as one of the five important parts of a bigger whole which is weaved with an intense social, cultural and historical values. And the people of the region represent a great extent diversity composing of students, academicians, artists, musicians, directors, performers, art lovers, craftsmen, traders; and every and each one of the has a unique discourse and demand in public life. And accordingly, the urban fabric is also weaved through this diversity: art galleries, movie houses, theater houses, studios, ateliers, museums, concert halls, historical places etc.

For this diversity to come to life, an incentive urban design system is proposed where the people arrange their unique acts along the region. With a number of 'locs' and a following route, people are considered to organize their events, gatherings, meetings, social activities etc. All are unique from each other, temporarily created and can be easily removed or changed by the people. 'locs' are integrated to represent the public solidarity for the people. And the main course, here, is to strengthen the role of people in city; to bring them in such a position where they all have the right to demand, right to be heard, right to be exist in a democratic and collective urban ground.



### Taksim Encounters

**WHAT WILL BRING PEOPLE TOGETHER THOROUGHOUT THE TAKSIM?**  
A space that is open to everyone from every gender, every age, every color every profession and from every position, and that space is a digital framework that is actually exposed to be a mutual ground for people.

The digital framework of the design case has actually a spatial dimension where no boundary is set and no restriction is drawn; and where every individual is welcome.

Also, this framework thoroughly represents the democratic base of this urban design approach since it allows every individual's unique narrative in city. Everyone is freely welcome to contribute. All the vibrant and colorful, cultural, social and vibrant activities are waiting for people to envision.

**HOW DOES IT EXACTLY WORK FOR PEOPLE?**  
With the partnership of the metropolitan municipality, a number of proposed temporary structures (locs) along the urban fabric are designated for various actions and events temporarily by the people; for people to participate in various ways.

Festivals, theatres, movies, competitions, gatherings, local biennals, local street markets and, news, announcements, donations and etc.

The main goal of this digital space is to bring an incentive platform for people to cultivate the urban life with diverse actions, experiences, memories and events. Also, it is aimed that people become more active, more in charge about the public life in city.

Also, it is important for the city to become a collective + creative ground for its dwellers. In other words, city becomes a democratic media, commonly used within an open-ended process.

**Digital Framework, as a democratic space for urban life**

**V. Taksim Encounters**

Sculpture Competitions	Pick Your Loc!
Open Air Movie Festivals	
Exhibitions	Select Your Date!
Workshops	Order Your Event
Markets	Share!
Concerts	
Open Air Educational Events	
Open Air Performances	
Theaters	

**Gezi Park Locs & Available Events**

**Potentials + Situations + Problems + Critics on Today's Gezi Park & Taksim Square**

- Gezi Park + Taksim Municipal Garden**

Gezi Park has been one of the most valuable asset in the present urban state of both Istanbul and Taksim. It was the first park of the Turkish Republican history, proposed by Henri Prost in 1940 to serve as a public space. Yet, despite its essential urban value and location, Gezi Park has not been used and functionalized well for people based on several reasons:

**The monumental state of Gezi Park**  
With its strong political memory, Gezi Park has been treated as if it is a giant urban monument. For a long time, Gezi Park has been perceived as an urban ornament to watch or to pass by; not to engage in or to perform any kind of daily activity, which is the most essential feature that an urban park should have. This situation doubtlessly makes the Gezi Park, as a solidified 'urban object', rather than a vibrant public space.

Also, this political heaviness of Taksim makes the urban life much more enclosed for people in an intangible manner. People, actually, hardly can try to interact with the space, get engaged with an abundant public life, encounter in a wide range of opportunities. And ultimately, in the scope of urban democracy, people had been excluded from the urban life.

**A kind of an introvert park: Gezi Park**  
Majority of the public circulation is concentrated around the Gezi Park, not within it. It is because of the inequality of the existing context of the Park.

Today, Gezi Park cannot meet the expectations of a vibrant public life. People mostly use the Park for only to pass by just as an ordinary urban passage.

**Physical envelope of Gezi Park:**  
Its current landscape design cannot allow people to reach into the Gezi Park physically. Steep edges and solid physical boundaries around the green locus make the Park isolated and out of context.

**Taksim Municipal Garden:**  
With its historical urban and public memory, Taksim Garden needs to be perceived as an extension part of the Gezi Park. It has a great amount of potential to become a serene and tranquil urban park.
- Taksim Square + Underground Encounters**

Taksim Square, as an urban piece, should be examined as a public ground attached to the Gezi Park. The relationship between the square and the Gezi Park is one of the most essential potentials of the Taksim Square, of which the main missing feature within the identity of Square, in today, is the disconnection to the Gezi Park. In other words, Taksim Square should be seen as a part of the holistic understanding of the landscape system.

Also, the lack of well-organized pedestrian orientation along the square surface is another missing part of the square as a public space.

**Underground life + safety:**  
Additionally, the underground level of the Taksim is another case on its own. The metro entrance points on the Square should be recognized as one of the most potential spaces in the context of public encounter.

Besides, the underground routes between the metro entrance points on the above surface should also be examined in the scope of the public safety since these spaces are vulnerable to be targeted for their climatological surface atmospheres.

In addition to the physical conditions, underground routes and metro entrances have a great deal of potential regarding the public encounter issue. These spaces can be utilized to open the public life to an experimental and socio-cultural engagements.
- Ataturk Cultural Palace + Ataturk Library**

**Culture Street Potential**  
Today, despite its spatial and public potential, Ataturk Library and its close vicinity is not connected to the Gezi Park and Taksim Square. It is obviously not unachievable, but the urban connectivity is not that strong either. Both ecologically and socially, these urban spaces should be integrated each other and to the public life as well.

To achieve that, the Culture Street of AKM should be assessed as an alternative route to Ataturk Library. Both accessibility-wise, and ecologically-wise, the green fabric of the urban area can easily become a united green patch.

**AKM + AKM Facade**  
Not to mention its cultural and social entity in the urban context, AKM represents a unique potential to public life with its facade. It can be used as a public media for various actions.
- Urban Ecology**

**Inconsistent Green Infrastructure:**  
The green fabric of today's Taksim represents an inconsistent and disconnected green patch. Especially in such an intense urban area like Taksim, ecological concerns are more than important to be assessed carefully.

To create wealthy public spaces, micro climatic conditions are essential for people to live in prosperity. In this sense, the effect of heat island, responsive water management, sustainable landscape design and well organized eco-friendly traffic issues are key to achieve a pleasant urban environment.

**Unbalanced Landscape + Softscape**  
+ Heat Island Effect

**%64** Hardscape (14,350 m<sup>2</sup>)  
**%36** Green Area (8,200 m<sup>2</sup>)

**Insufficient Water Management:**  
The weak landscaping and landscaping arrangements of existing state of Gezi Park and Taksim Square lacks of sufficient water management. Absence of sustainable landscape strategies and inaccurate material usages represents a total failure in regarding with the urban ecology.





**%56** Landscape Remains  
89.250 m<sup>2</sup>  
**%44** Green Area Proposed  
76.250 m<sup>2</sup>

**A Section**



**B Section**



**C Section**

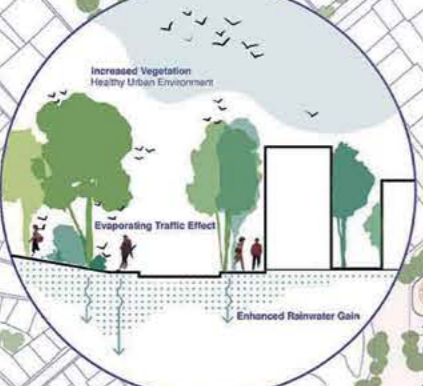

**Design Strategies**

**1. Renovation of Urban Road Network**

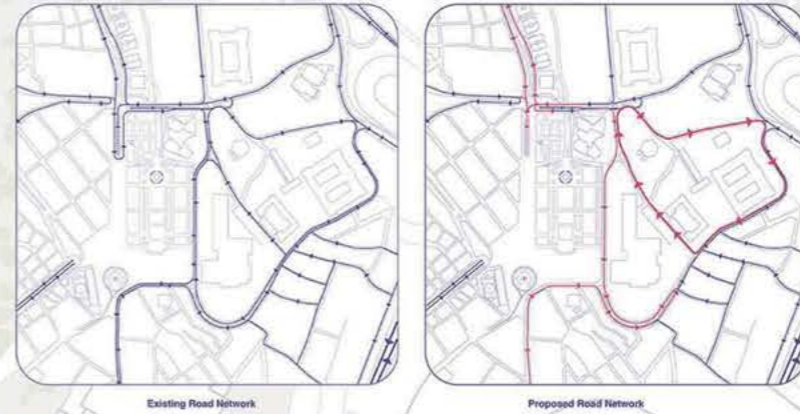

**Reorganizing Transportation and Road Network**

In a such urban environment like Taksim, vehicle intensity and congested traffic conditions are one of the most important urban issues in today's city life.

Especially, around the Gezi Park and Taksim, in the context of urban ecology and urban health, new road network reorganization has been proposed to make urban life more livable and healthy.

With the traffic evaporation strategy, Mese Street and Taksim-Zafer Street has been reduced to one way direction. With this, section of these streets are now can be transformed into a more green, more public, more walkable urban corridors.

Urban pollution issue, also, now can be taken into consideration since the new spatial public opportunities are emerged.

Moreover, noise pollution also can be reduced since the number of vehicle using these roads are reduced and streets are belong to more pedestrians more than before.

**2. Gezi Park Reviving & Preservation**

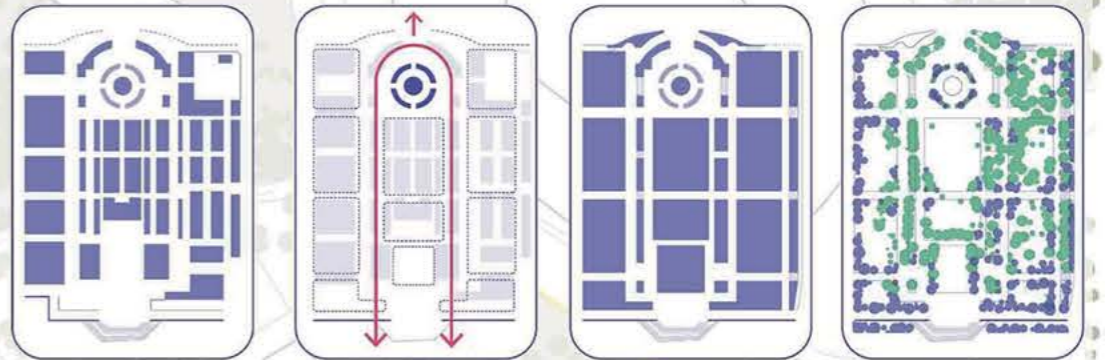

**Existing Gezi Park Spatial State**

Weak spatial organisation, too much unusable fragmented green fabric.

**Preserving Existing Direction**

Keeping the current major axis maintained, in respect to the public memory and memorial urban circulation.

**Recuperation of Spaces**

Reconnect the fragmented green spaces into more holistic and usable ground. Making it open to more people, more possibilities, more event opportunities.

**Enhancement of Current Vegetation**

With additional plantation strategy, urban heat island impact, health of urban environment, spatial orientation is rehabilitated.

**3. Improving Existing Urban Ecology**



**Continuity of Green Patch & Corridors**

The existing fragmentation of green traces in the urban scale is making this already interrelated urban area even more vulnerable to urban side-effects. The concerns of urban ecology becomes more and more important in a such interrelated urban environment like Taksim.

Thus, it is crucial to lowering the severe climatic effects of the urban area, to reduce the urban heat island effect, to emerge healthy environments, to create aesthetically pleased streets and squares, additional landscape system is proposed all along the urban scale. From Gezi Park to the Harbiye, Beşiktaş, and Galata region, a series of plantation strategies are emerged throughout the existing urban context.

**Lowering Existing Urban Intensity Effects**

Decreasing urban heat island effect with more permeable and green surfacings.

Proposed native and local plant species for better adaptation and to ensure low maintenance efforts.

Plantation in accordance to slopes and existing physical urban content to improve water management and to get better off from the sustainable environment.

Not to use same species constantly, to provide more visual rehabilitation to create therapeutic urban environments.

**4. Revised & Holistic Taksim Square Ground**

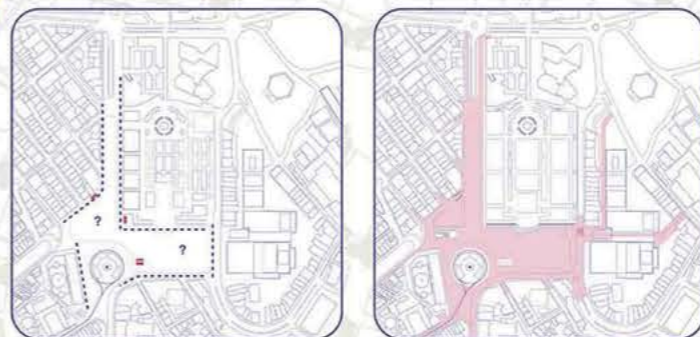

**Bettering the Recognisability of Taksim Environment**

To annihilate the undefined atmosphere of Taksim Square and its relationship with its close vicinity, an inclusive and historically embracing total ground is proposed.

To enhance its relationship with Atatürk Cultural Palace, Atatürk Library, Gezi Park, İskitlil Street, Cumhuriyet Street and Tarlabaşı Boulevard, the easily traceable urban surface is proposed to make the Taksim area more traceable and defined by its own way.

This totalitarian is also an intangible touch to the context of holistic and democratic urban design philosophy.

To make it defined, any kind of defined design interventions have not been made in Taksim environment. It is a kind of design concept that covers the Taksim regions the events that will be created by the people itself.

To achieve that socially inclusive design philosophy, an inclusive and embracing urban ground is proposed, which welcomes every urbanite from any region of the city.



Underground Plan I 1:1000

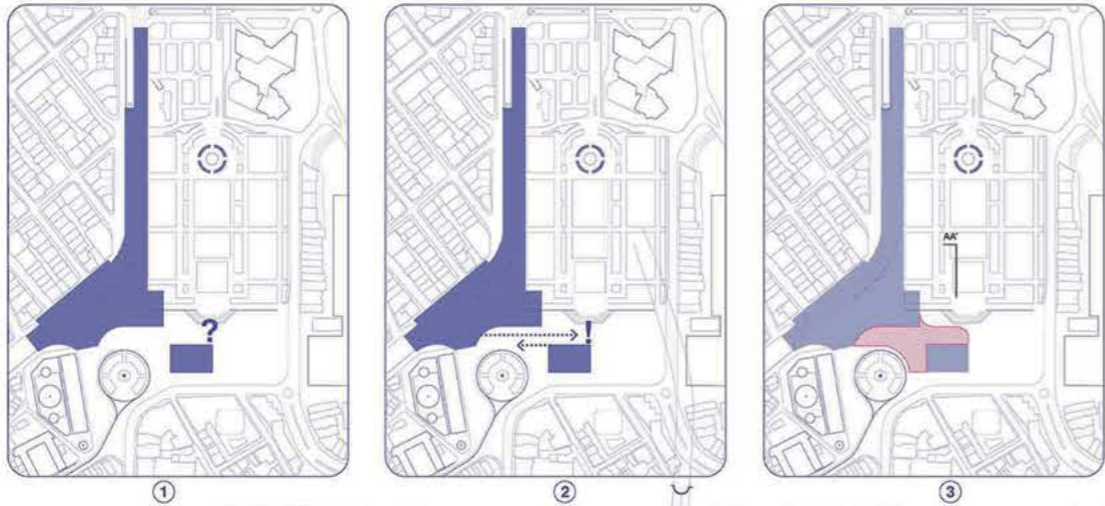

5. Revitalizing Underground Infrastructure

**New regulating of underground urban layer:**  
Combining two separate underground units to create better navigating and circulation along the underground atmosphere. Also to renovate the above ground squares, new metro entrances are proposed in order to arrange more defined and better steering public ground.

**To unlock the broken relationship between above and below ground environments,** more accessible metro entrances are proposed to increase the opportunities for further social encounters.

**Refurbished underground life of Taksim:**  
The current atmospheric conditions of underground layer of Taksim are dominated with only a passage use. Which outstandingly creates a public potential for it to become a underground carpool where people are able to encounter with the space and with each other to share sports activities, events and daily acts.

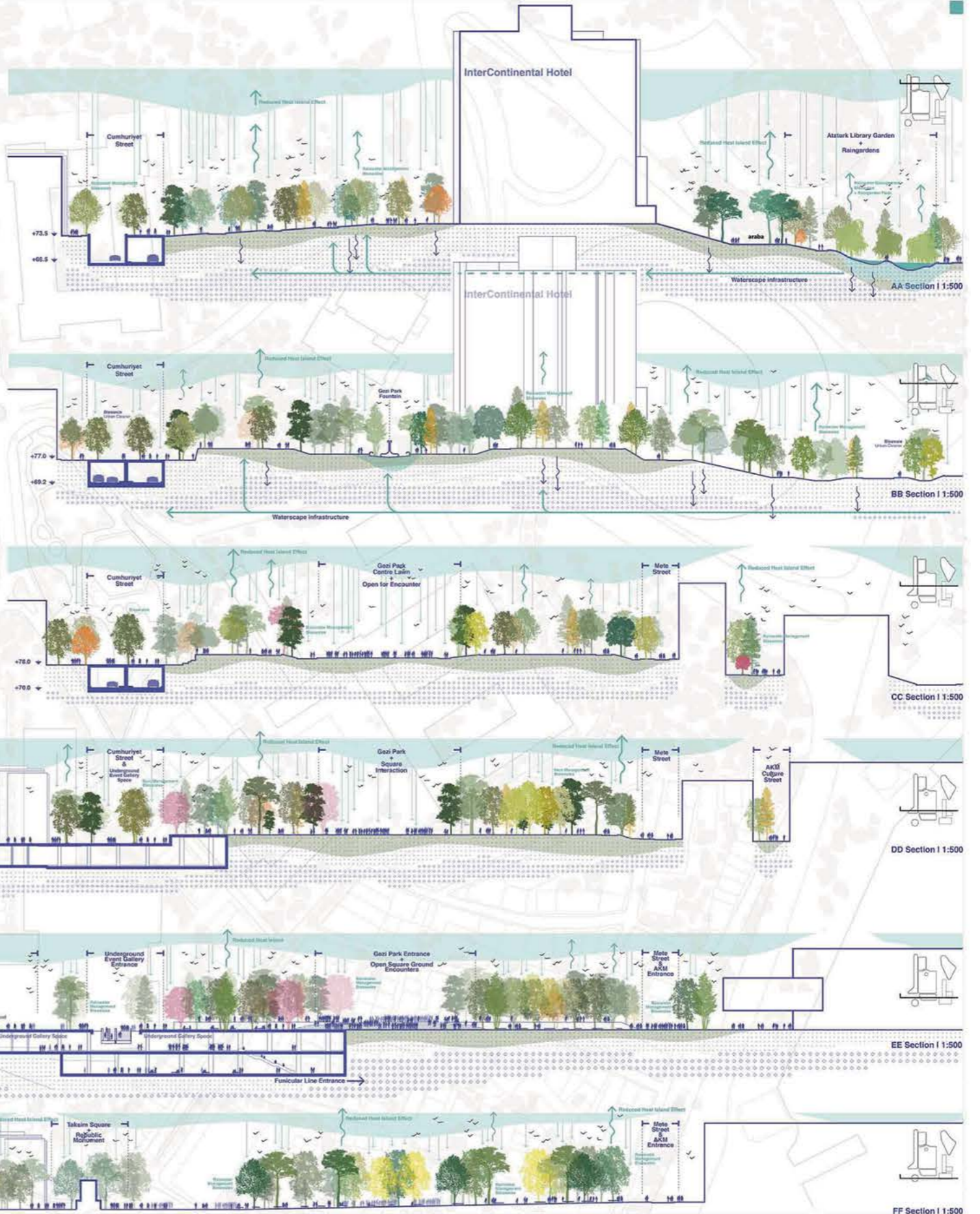
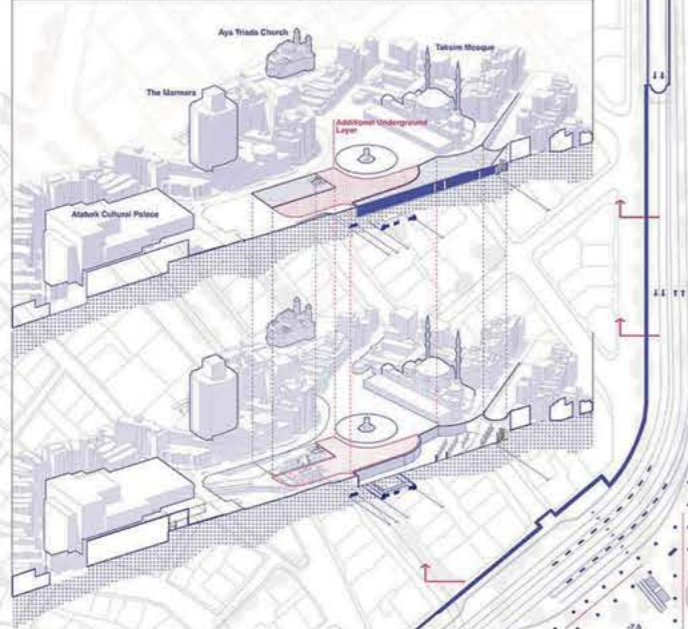
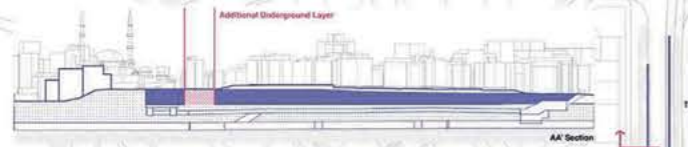
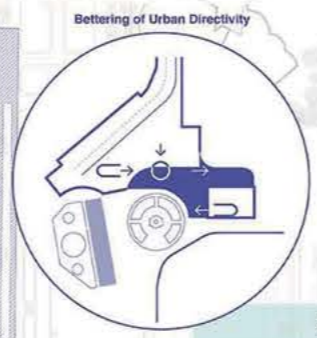



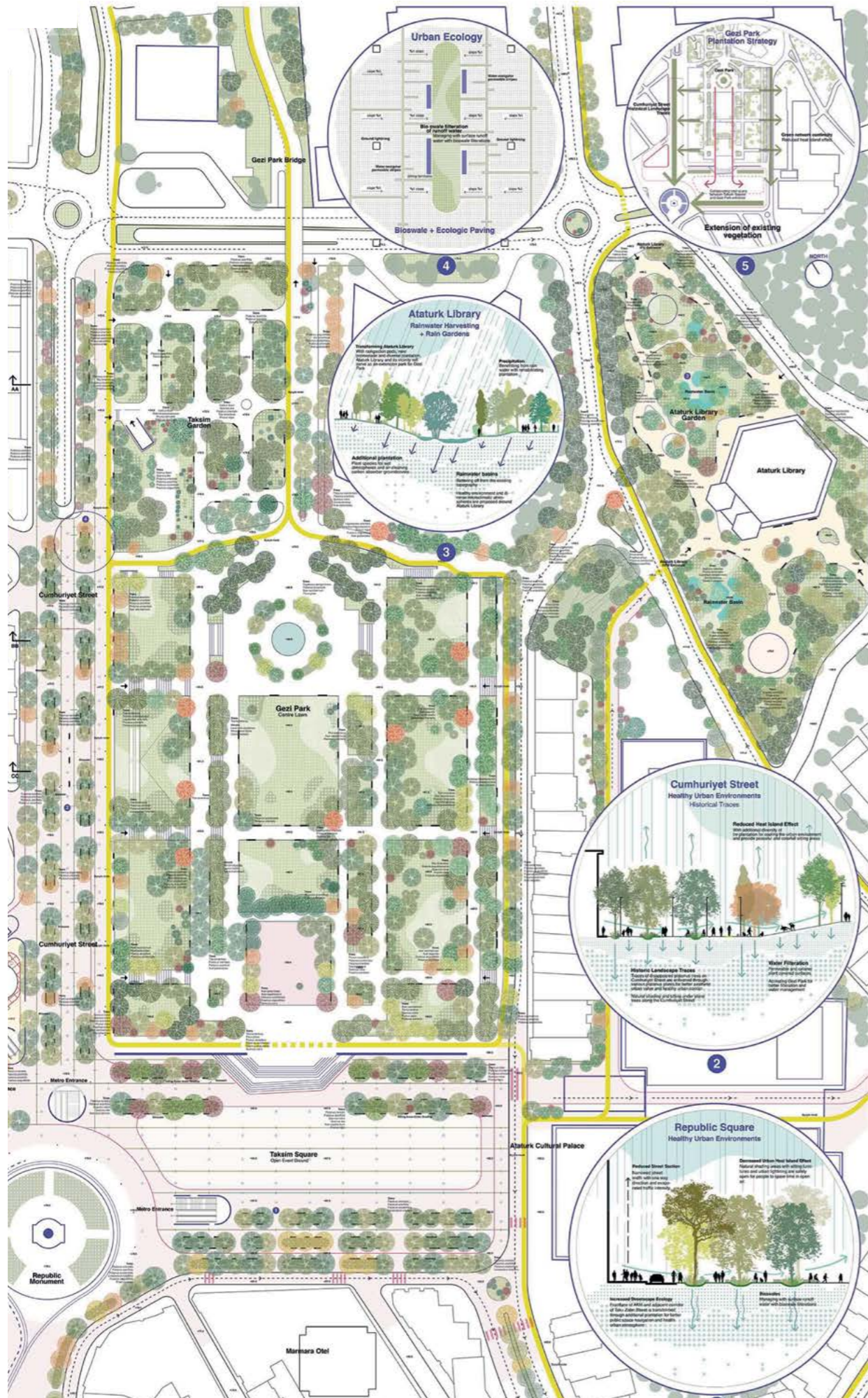

**Cumhuriyet Street**  
An Open Public Corridor Aroused from The Historical Traces



**Gezi Park Centre Lawn**  
A Centric Public Carpet for Exchange of Public Programs



**Taksim Community Chamber**  
Semi Public Spatial Hub for Organisational Assemblies



**Republic Square**  
Urban Navigator Ground with Surrounding Relationships



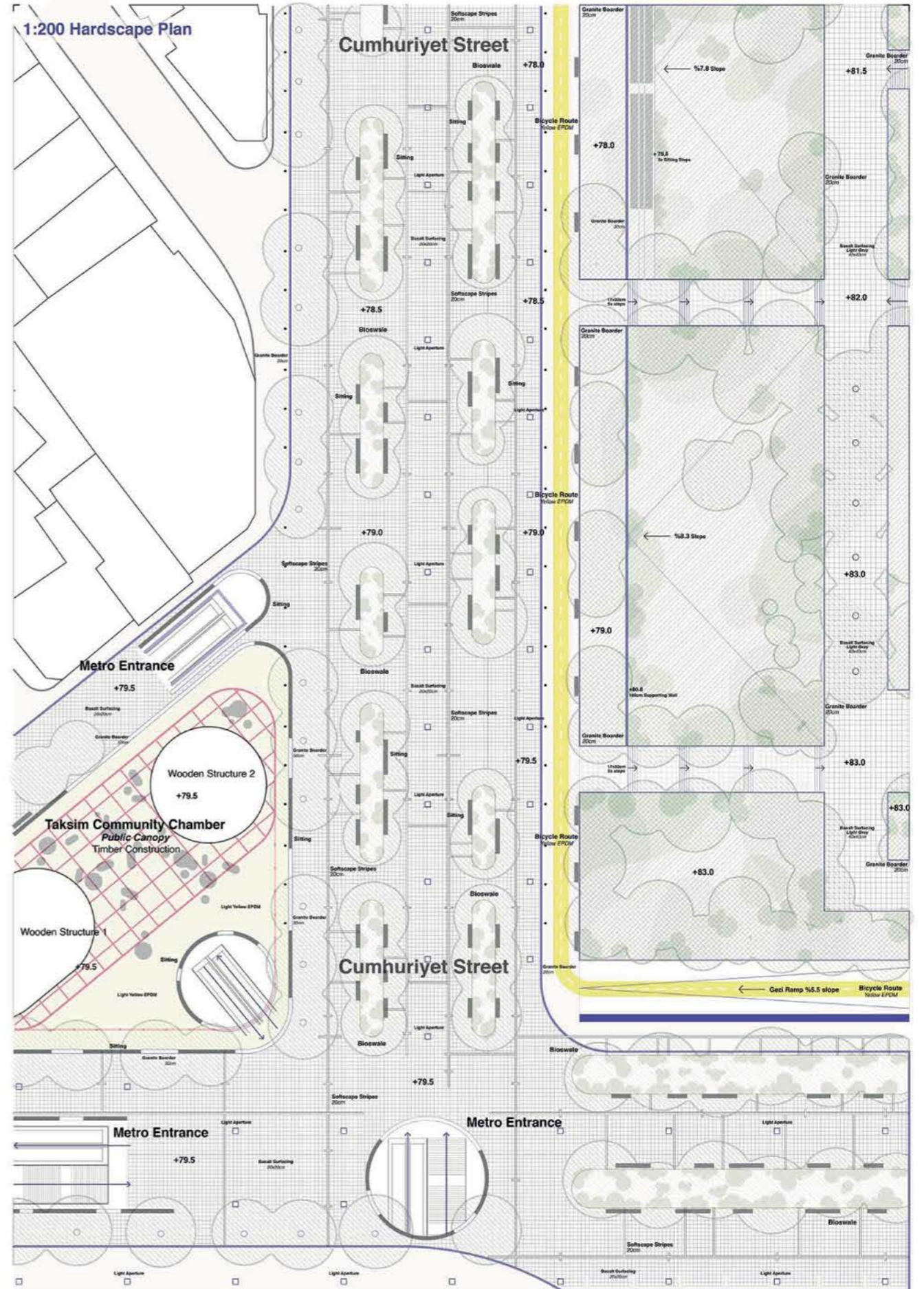
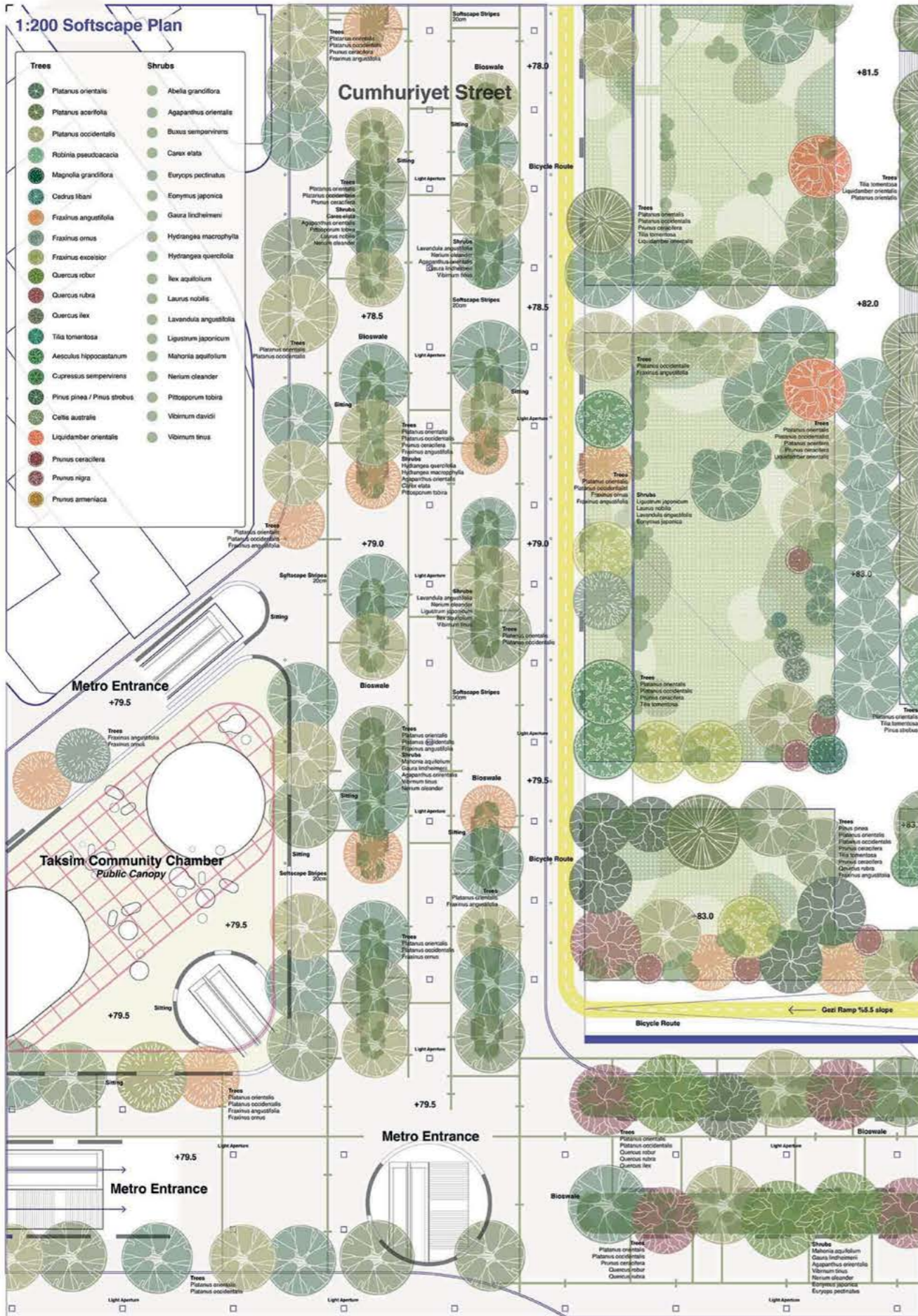



To achieve all of these abstract approaches on the site, the axis of the Cumhuriyet Street has been strengthened through regenerating the immemorial traces of the historical plane trees and transformed into a navigating and healthy urban corridor with the water management and bio-swale strategies. Gezi Park has been transformed from its monumentalized and frozen status into a much more vivid and welcoming alive public park through reorganizing its spatiality, constitution of the open-use Locis and the Taksim Community Chamber, the integration with the Republic Square and the recuperation the existing vegetation with native species. Republic Square, also, has been reshaped through its historical traces animating its memorial value, fulfilled with the approach of "open-use public carpet", navigated to the Ataturk Cultural Palace's facade, and integrated with the underground level of Taksim in a much more holistic manner with the lighter, wider and relocated metro entrances.

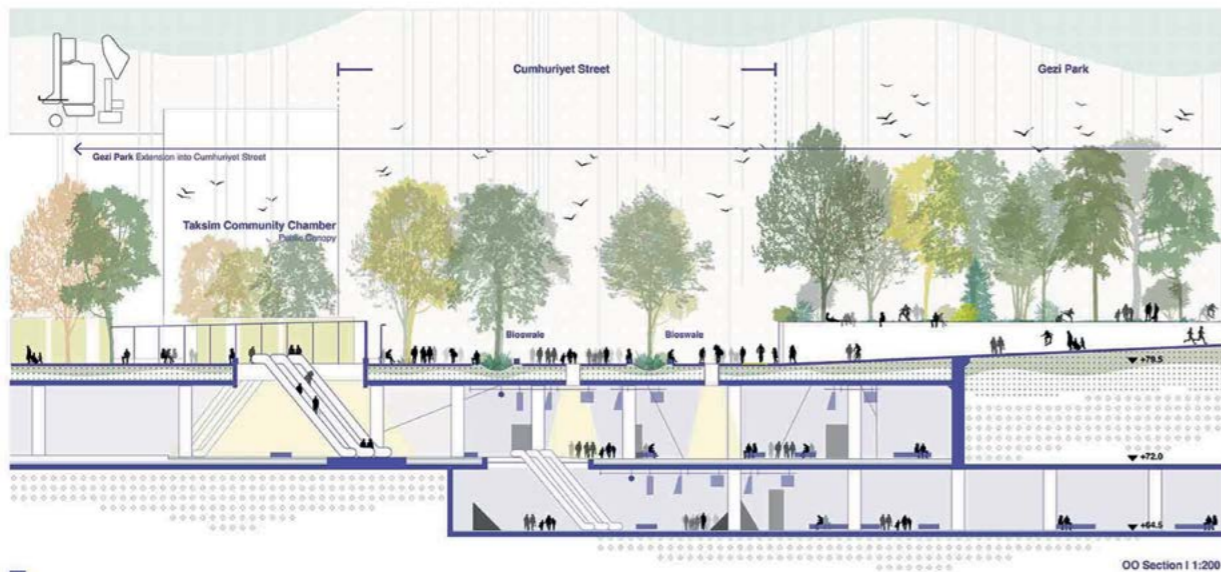
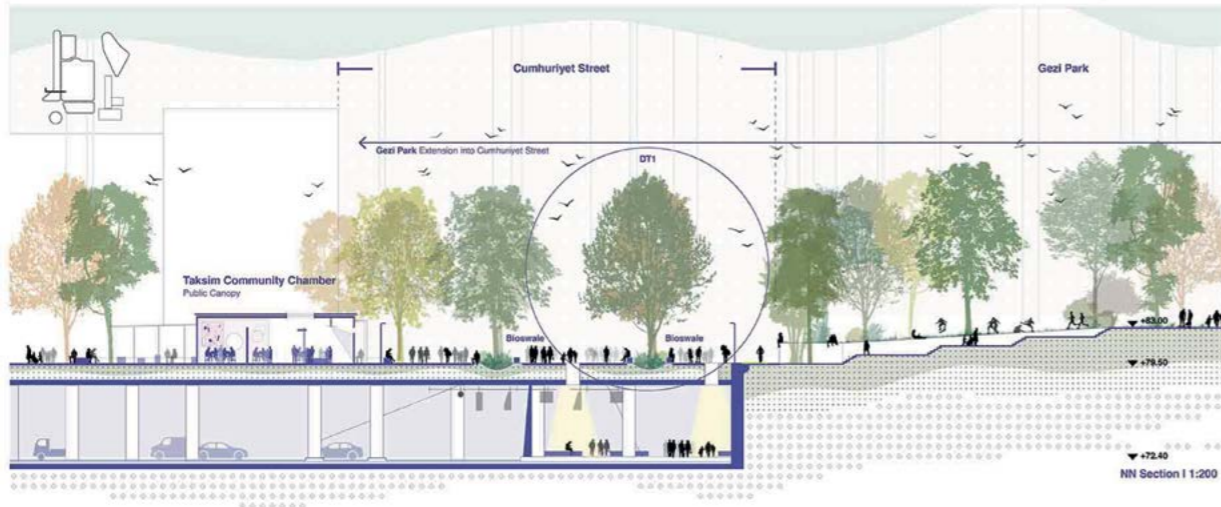
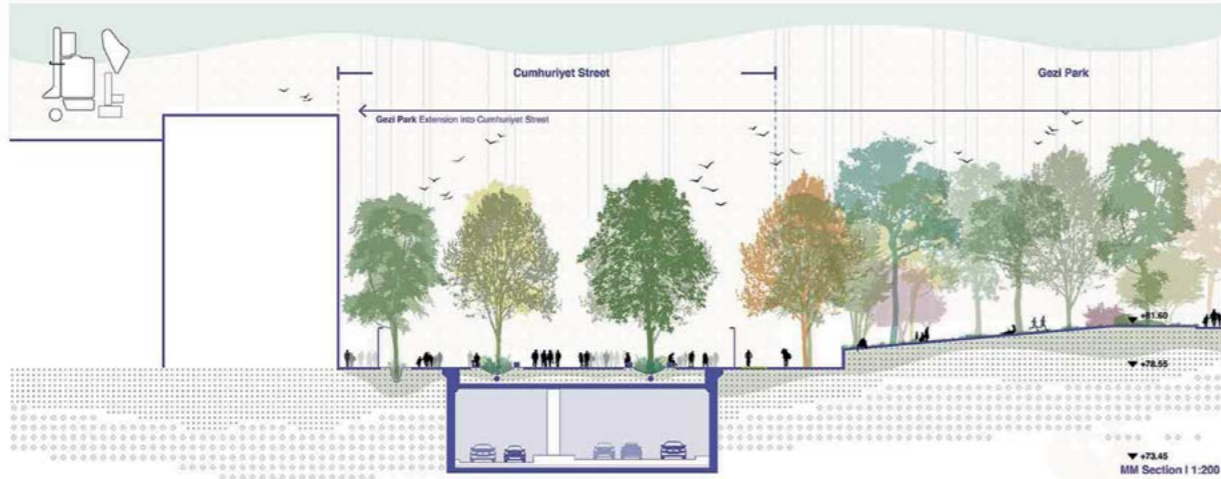

And moreover, underground level of Taksim has been reunited with the existing detached spaces in order to acquire a safe and total space which serves as a lively activity ground. Apart from these, for the sake of creating a clean and healthy urban environment, traffic around the square has been reduced through narrowing the Tak-i Zafer Street and Mete Street which will serve for only the mass transportation.

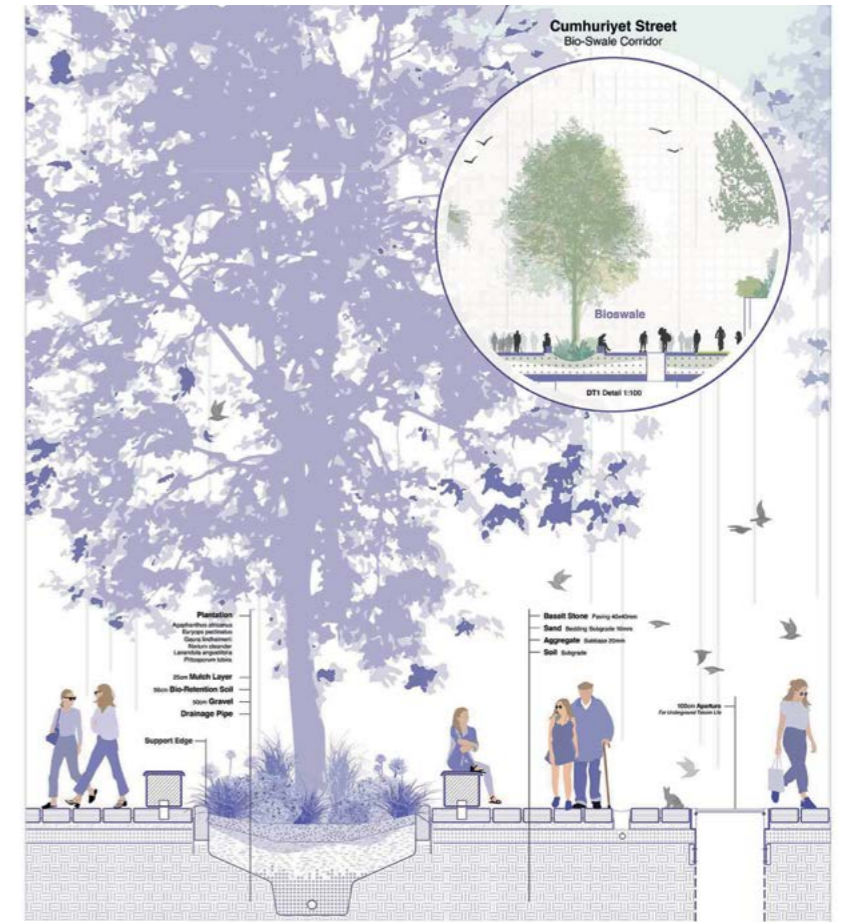

### Activities & Encounters

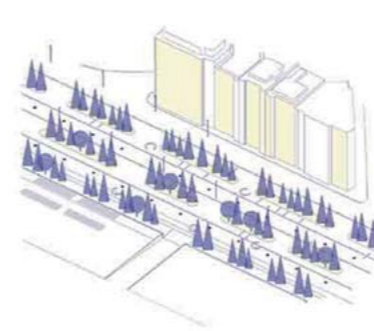

**Cumhuriyet Street**  
The historical traces of old plane trees, bio swale axis, the new open relationship with Gezi, healthiness and greener eco-corridor for this Encountering system... Cumhuriyet Street is now not just a cleaner urban corridor, but also a linear path for temporary commercial sites for merchants nearby!

**Regulation for Local Labour**  
From now, the street, closest park, water seller by foot and every local labour of Taksim are freely allowed to wander around those mini local! They are not stabilized any more! The visibility and the original romance of Taksim is back!

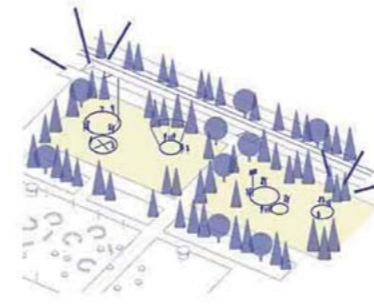

**Gezi Assemblies & Playground**  
From its frozen state to this lively vivid atmosphere, Gezi has been expected to serve, also, for the daily small activities besides the grand actions. Sports, gatherings, rest spaces, fountains and etc. Can be demanded or booked through the app!



**Gezi Centre Lawn**  
As a part of the recuperation of Gezi Park, the central lawn space of Gezi has been planned to widen its spatial and social opportunities with flexible public programs. Open air theatres, concerts, cinema festivals, sport activities, resting and so on... All is in the Taksim Encounters App!

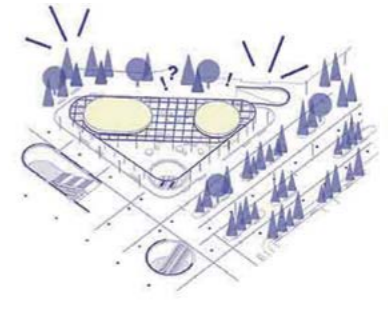

**Taksim Community Chamber**  
As the physical space of the digital framework of the process (Taksim Encounters), Taksim Community Chamber's social canopy is thought as a gathering ground for ideas and meetings of the organizational background of Taksim Encounters! Stay tuned for the news, go to app!

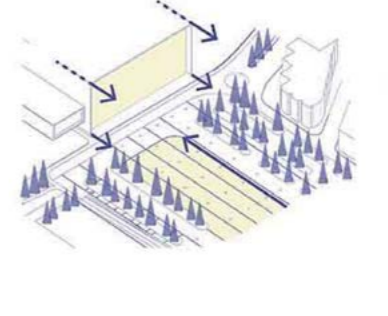

**AKM Urban Media Facade**  
With its historical and cultural impact to the city around it, Ataturk Cultural Center has been considered not as a cultural house but also an active urban media facade with its frontage inter-related with the square and public life around it. Digital 2d exhibitions, movie night projections and etc.

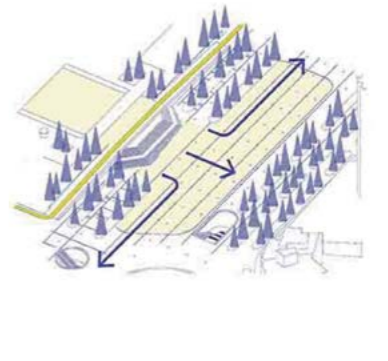
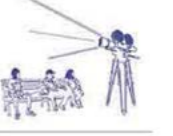

**Taksim Republic Square**  
For people to shout out their narrations, protests, ideas and any kind of discourses, Taksim Republic Square has been perceived as an open public ground for various actions. The exchange of programs along the square like open air assemblies, festivals, benefits and etc. within an organizational support.





# DESIGNER WHO ?



Who is the DESIGNER of Taksim?

>Lorem ipsum dolor sit amet, consectetur adipiscing elit, sed diam nonummy nibh euismod tincidunt ut laoreet dolore magna aliquam erat volutpat. Ut wisi enim ad minim veniam, quis nostrud exerci tation ullamcorper suscipit lobortis nisl ut aliquip ex ea commodo consequat. Duis autem vel eum irure dolor in hendrerit in vulputate velit esse molestie consequat, vel illum dolore eu feugiat nulla facilisis at vero eros et accumsan et iusto odio dignissim qui blandit praesent luptatum zanti doreni augue dui dolorem te feugit nulla facilis.

>Lorem ipsum dolor sit amet, consectetur adipiscing elit, sed diam nonummy nibh euismod tincidunt ut laoreet dolore magna aliquam erat volutpat. Ut wisi enim ad minim veniam, quis nostrud exerci tation ullamcorper suscipit lobortis nisl ut aliquip ex ea commodo consequat. Duis autem vel eum irure dolor in hendrerit in vulputate velit esse molestie consequat, vel illum dolore eu feugiat nulla facilisis at vero eros et accumsan et iusto odio dignissim qui blandit praesent luptatum zanti doreni augue dui dolorem te feugit nulla facilis.

>Lorem ipsum dolor sit amet, consectetur adipiscing elit, sed diam nonummy nibh euismod tincidunt ut laoreet dolore magna aliquam erat volutpat. Ut wisi enim ad minim veniam, quis nostrud exerci tation ullamcorper suscipit lobortis nisl ut aliquip ex ea commodo consequat. Duis autem vel eum irure dolor in hendrerit in vulputate velit esse molestie consequat, vel illum dolore eu feugiat nulla facilisis at vero eros et accumsan et iusto odio dignissim qui blandit praesent luptatum zanti doreni augue dui dolorem te feugit nulla facilis.

## Loci Organisation & Taksim Life

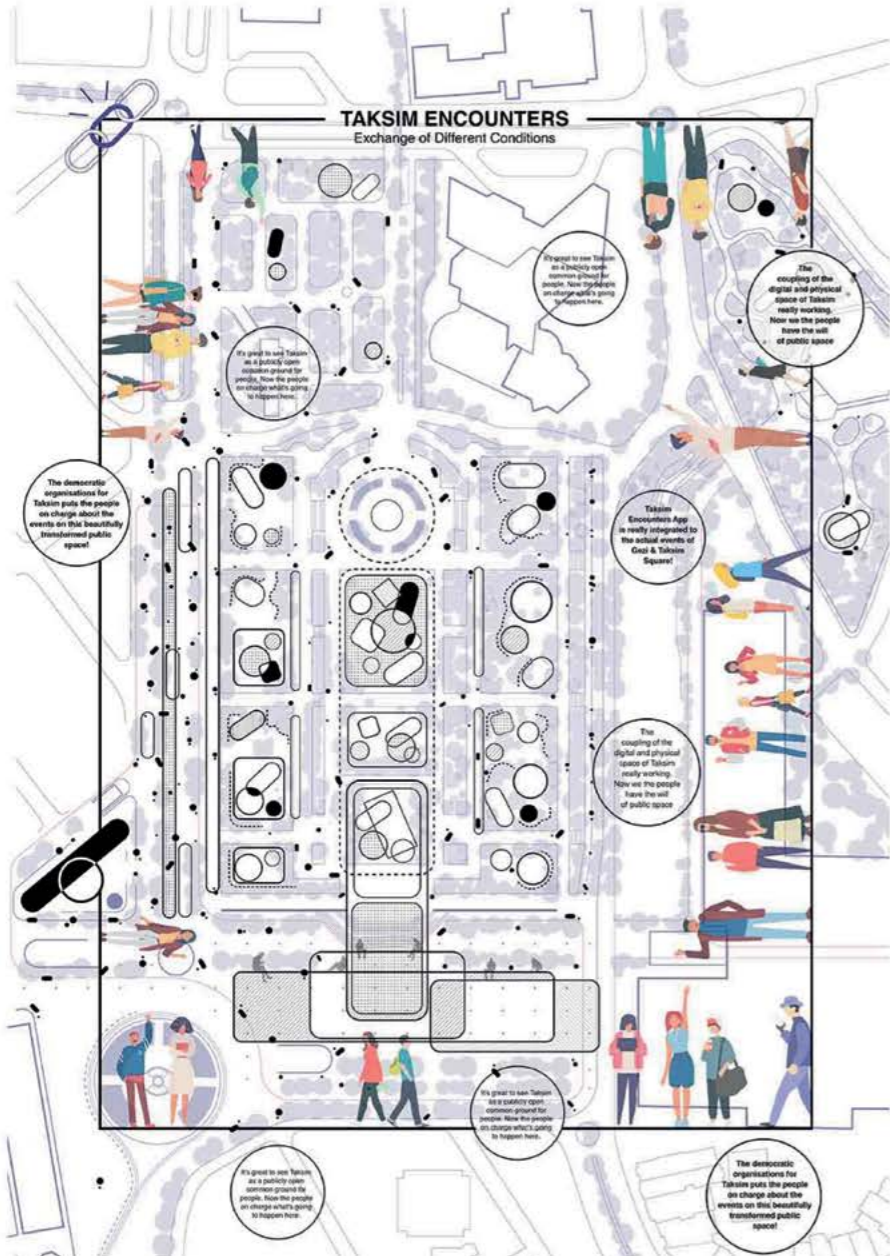



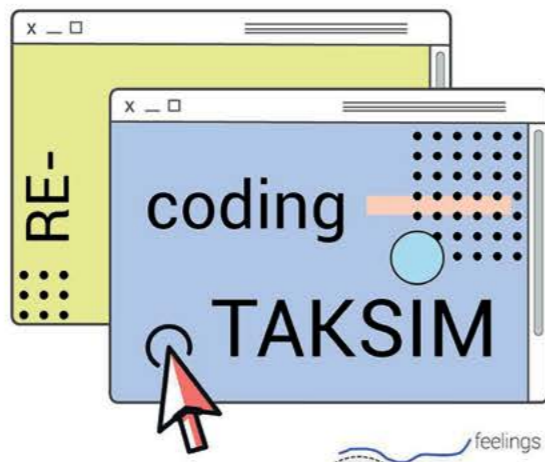

code /kəʊd/

- noun**
1. a system of words, letters, figures, or symbols used to represent others, especially for the purposes of secrecy.
  2. a phrase or concept used to represent another in an indirect way.
  3. a series of letters, numbers, or symbols assigned to something for the purposes of classification or identification.
- verb**
1. (computing) program instructions.
  2. a systematic collection of laws or statutes.
  3. a set of conventions or moral principles governing behaviour in a particular sphere.

Coding can be described as the traces of expression that appear at the interface of language and thought, or as the effect (s) that reveal how the associations that constitute every kind of expression mediated by thought are constructed by certain actors. The effort of spatial practices to codify a given time-space simultaneously and / or sequentially in certain directions leads to implicit or explicit stratification of different codes in the form of nodes for the space. The phenomenon called "urban memory" can be grasped through these stratified nodes. These nodal layers are re-exposed and re-encoded through practices at different time intervals, or they are gradually rendered invisible.

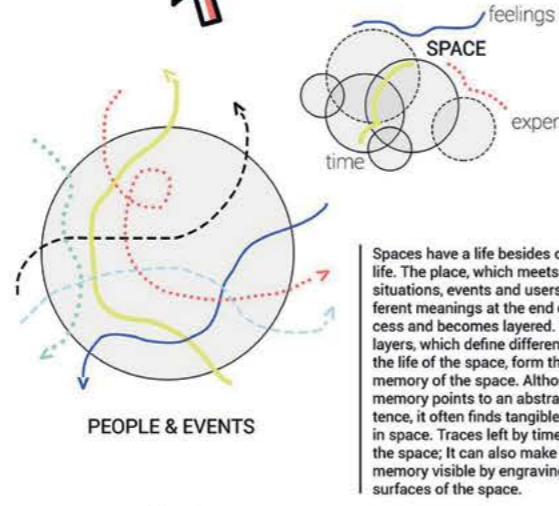

The events and experiences in the memory are not independent of space, and spaces are not remembered independently of the events and experiences that leave traces in the memory.

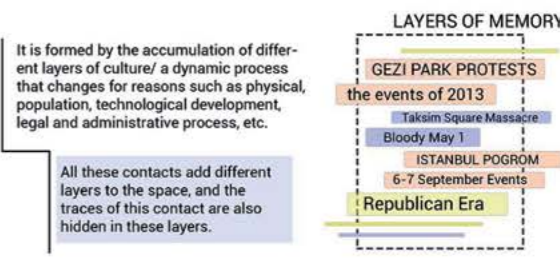
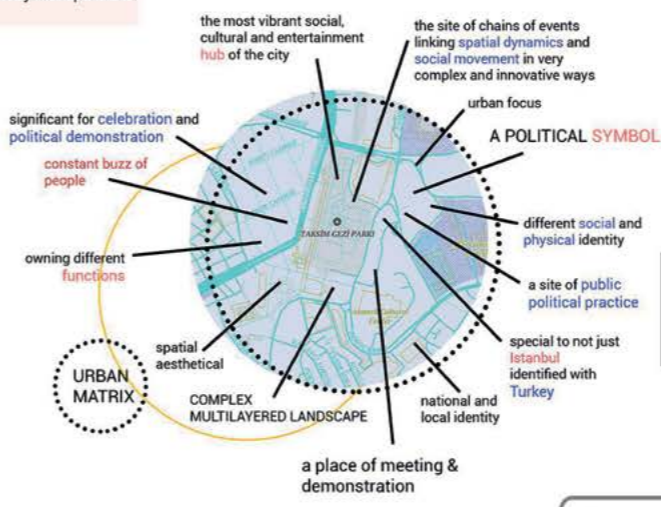
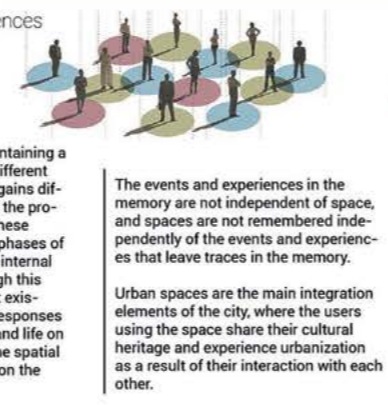

**CODING TAKSIM**  
ECE ŞENGÜL

In this project, starting from the identity of the square and its surroundings, the historical process of change, and collective memory, new coding styles were developed for these noteworthy concepts such as lack of contact, spacelessness, restriction, and inequality to update the region. At the same time, with these new codes created; it is aimed to make it more fair, equal, free, dynamic and attractive. In addition to the planning of the physical space, it is aimed to plan and develop the square digitally. We are now in the middle of a digital age, and when today's situations such as social distancing and pandemics are considered, everything is now becoming digital.

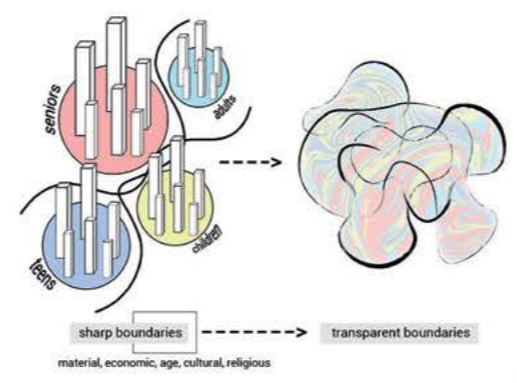
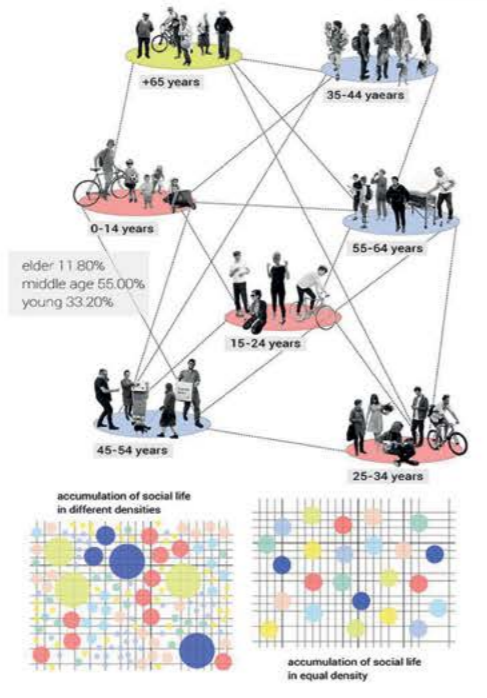

Town squares are an important urban life focus that reveals the identity and personality of our cities throughout history. Just as each person has their own characteristics, identity and personality, cities also have their own identity and personality. Like a loop, people and spaces affect each other and their identities change/transform within the process.

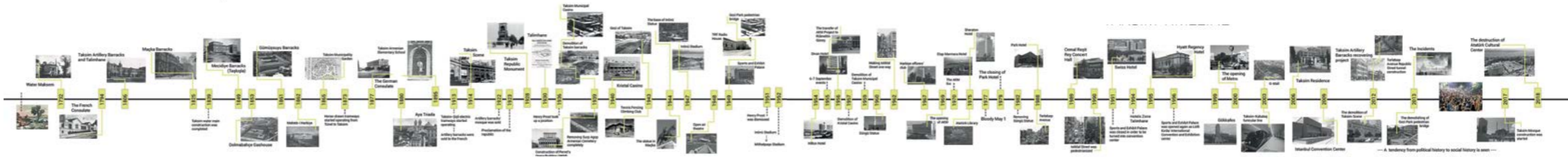
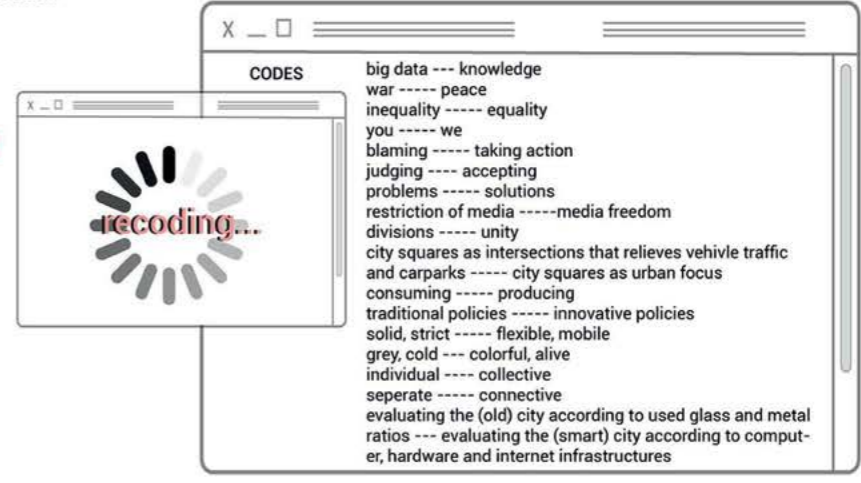
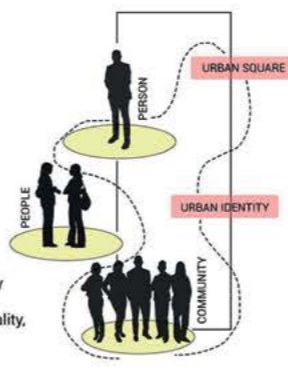



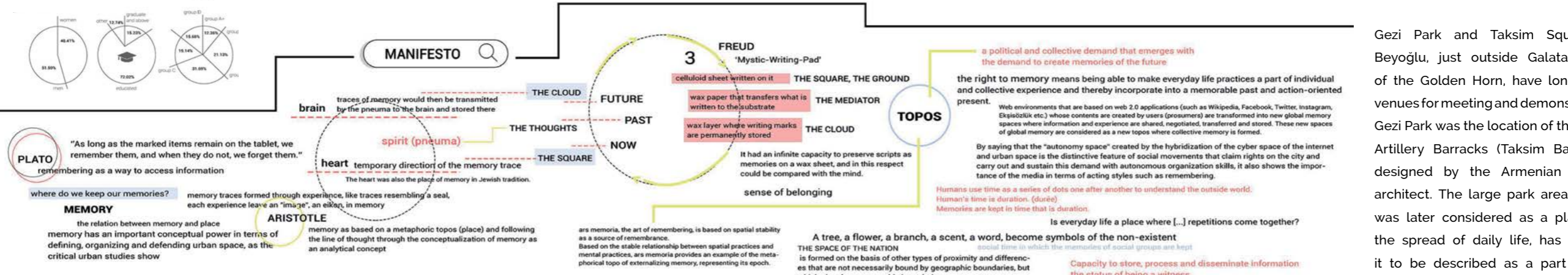
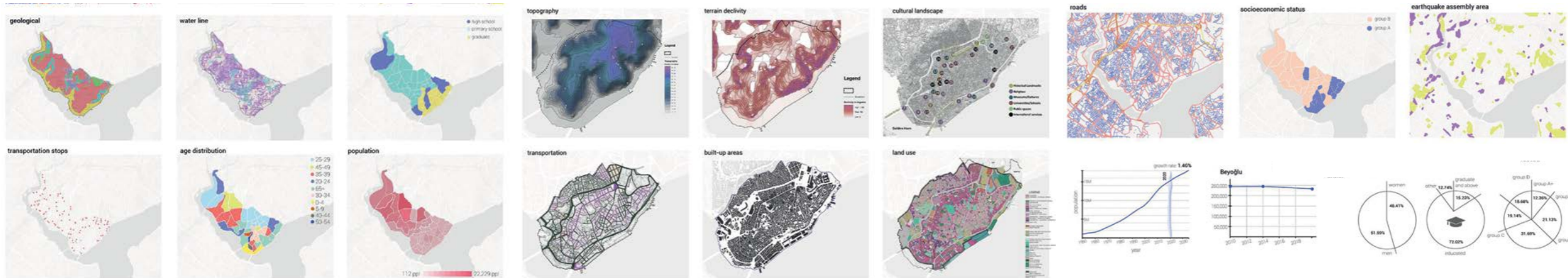

2021 TAKSİM // event calendar											
JANUARY	FEBRUARY	MARCH	APRIL	MAY	JUNE	JULY	AUGUST	SEPTEMBER	OCTOBER	NOVEMBER	DECEMBER
1 New Year's Day 2 National Science Fiction Day 3 JRRR Tolkien Day 6 Three Kings Day 12 National Youth Day 15 Martin Luther King's Birthday 21 Museum Selfie Day 25 Chinese New Year 26 Australia Day 27 International Holocaust Remembrance Day	2 Candelmas Day, National Ukulele Day, Super Bowl Sunday 11 International Day of Women and Girls in Science, Safer Internet Day 17 Ash Wednesday 25 Mardi Gras 28 Rare Disease Day	1 St. David's Day 7 National Be Heard Day 8 International Women's Day 9 Purim 14 National Pi Day 15 Red Nose Day 17 St. Patrick's Day 20 French Language Day, International Day of Happiness, Spring Equinox 25 Maryland Day 30 Doctors' Day	1 April Fools' Day, Istanbul Tulip Festival (whole month) 4 Easter Day 8 Passover, Maundy Thursday 9 Good Friday 10 Day of Silence 13 Ramadan 20 Chinese Language Day 22 Earth Day 23 St. George's Day, National Sovereignty and Children's Day 25 Anzac Day 28 National Superhero Day 29 International Dance Day	1 International Harry Potter Day, May Day, Workers' Day 4 Star Wars Day 5 Cinco de Mayo 6 National Nurses Day 7 National Day of Prayer, National Tourism Day 9 Ira and Mira, Mother's Day 16 National Honor Our LGBT Elders Day 19 Commemoration of Atatürk, Youth and Sports Day 28 Shavuot	2 Global Running Day 3 World Bicycle Day 5 World Environment Day 6 Russian Language Day 16 International Day of the African Child 20 Summer Solstice, Father's Day 21 International Yoga Day 24 Midsummer, Saint-Jean-Baptiste Day 25 Global Bealies Day 30 Social Media Day	1 Canada Day 4 Independence Day 5 Aalaha Pua, First Day of NAIQOC Week 11 World Population Day 12 Organisms Day 14 Bastille Day 15 Democracy and National Unity Day 18 Nelson Mandela International Day, World Listening Day 20 National Moon Day 29 Day of Arafat 31 Eid al-Adha, Harry Potter's Birthday	2 National Friendship Day 3 British Columbia Day, Civic Holiday 7 International Beer Day 8 Global sleep under the stars night 9 Islamic New Year 13 European Heritage Days 19 World Indian Independence Day 21 World Photo Day 22 International Day of Peace 30 Victory Day	1 Pithu Paksha 5 International Day of Charity 7 Labor Day 8 International Literacy Day 12 German Language Day 13 European Heritage Days 15 International Day of Democracy 18 Rosh Hashanah 19 National Dance Day 21 International Day of Peace 22 Fall Equinox 24 Heritage Day 26 Hoshana Rabbani 29 National Coffee Day	1 Mid-Autumn Festival, International Coffee Day 2 International Day of Non-Violence, Sukkot 3 National Poetry Day 5 World Teachers' Day 10 Columbus Day, Farmers Day 14 Diwali 17 Navratri 20 Transgender Day of Remembrance, Universal Children's Day 25 Thanksgiving 27 Navy Day 29 Republic Day of Turkey 30 Milad an-Nabi (Mawlid) 31 Halloween	1 Daylight Saving Day, National Author's Day, World Vegan Day 2 Day of the Dead 10 Atatürk Remembrance Day 11 Remembrance/Veterans Day, Singles Day 13 World Kindness Day 14 Diwali 20 Transgender Day of Remembrance, Universal Children's Day 25 Christmas 27 Navy Day 29 Republic Day of Turkey 30 Milad an-Nabi (Mawlid) 31 Halloween	3 World Day of the Handicapped 5 International Volunteer Day 6 St. Nicholas Day 10 Human Rights Day 12 National Poinsettia Day 18 Arabic Language Day 20 International Human Solidarity Day 21 Winter Solstice 25 Christmas 26 Kwanzaa 31 New Year's Eve, Hogmanay

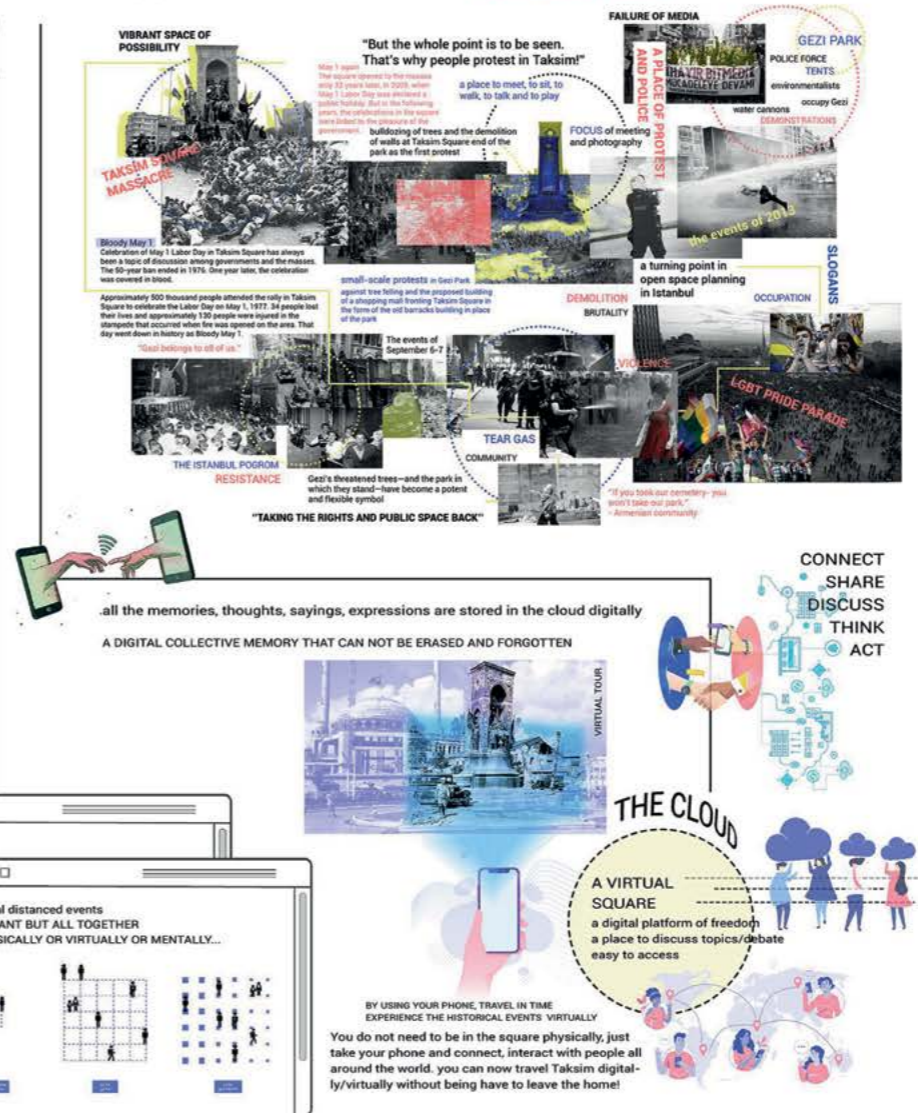

Gezi Park and Taksim Square in Beyoğlu, just outside Galata, north of the Golden Horn, have long been venues for meeting and demonstration. Gezi Park was the location of the Great Artillery Barracks (Taksim Barracks), designed by the Armenian palace architect. The large park area, which was later considered as a place for the spread of daily life, has caused it to be described as a part of the city, which is understood as a place of representations/demonstrations by different administrations, beyond being an inner-city geographical place, and for this reason, this place appeared to us that it is an area of constant discussion/squabble. It can be said that the content of these discussions points to a wide record scale ranging from social events to legal fights. One of the biggest problems is that the Gezi Park area, where the social life accumulates in different densities, could not make sufficient contact with the surrounding density. These problems are similar to Taksim Square. Taksim Square, built on the memories of the Republic, is an energy center and an important urban focus, settled in the urban memory, where people meet. In the period that has passed from its history to the present, the development of the city, which has grown rapidly with the developing technology, without taking into account its interaction with its environment, the increasing vehicle traffic in proportion to the population, and the regulations made, turned the square into a crossroad and faced the problem of losing the square's identity.



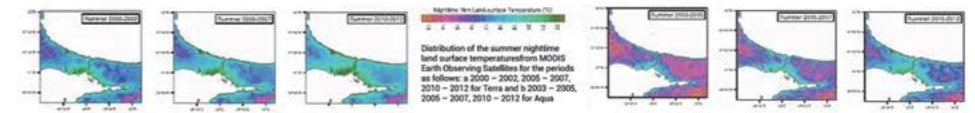
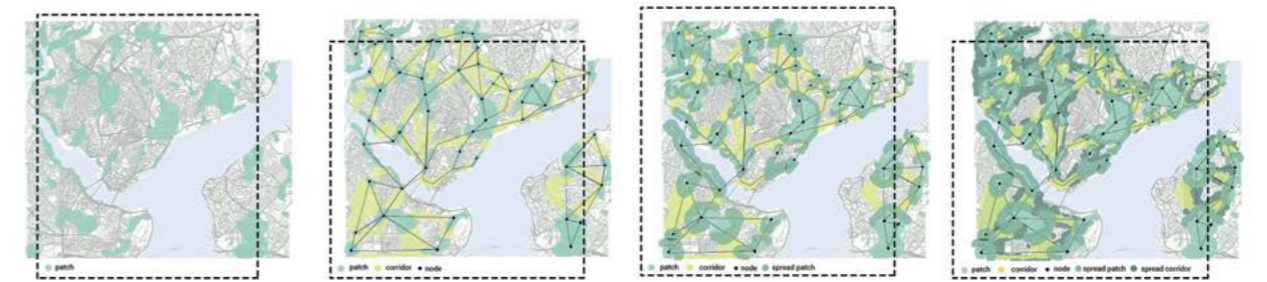
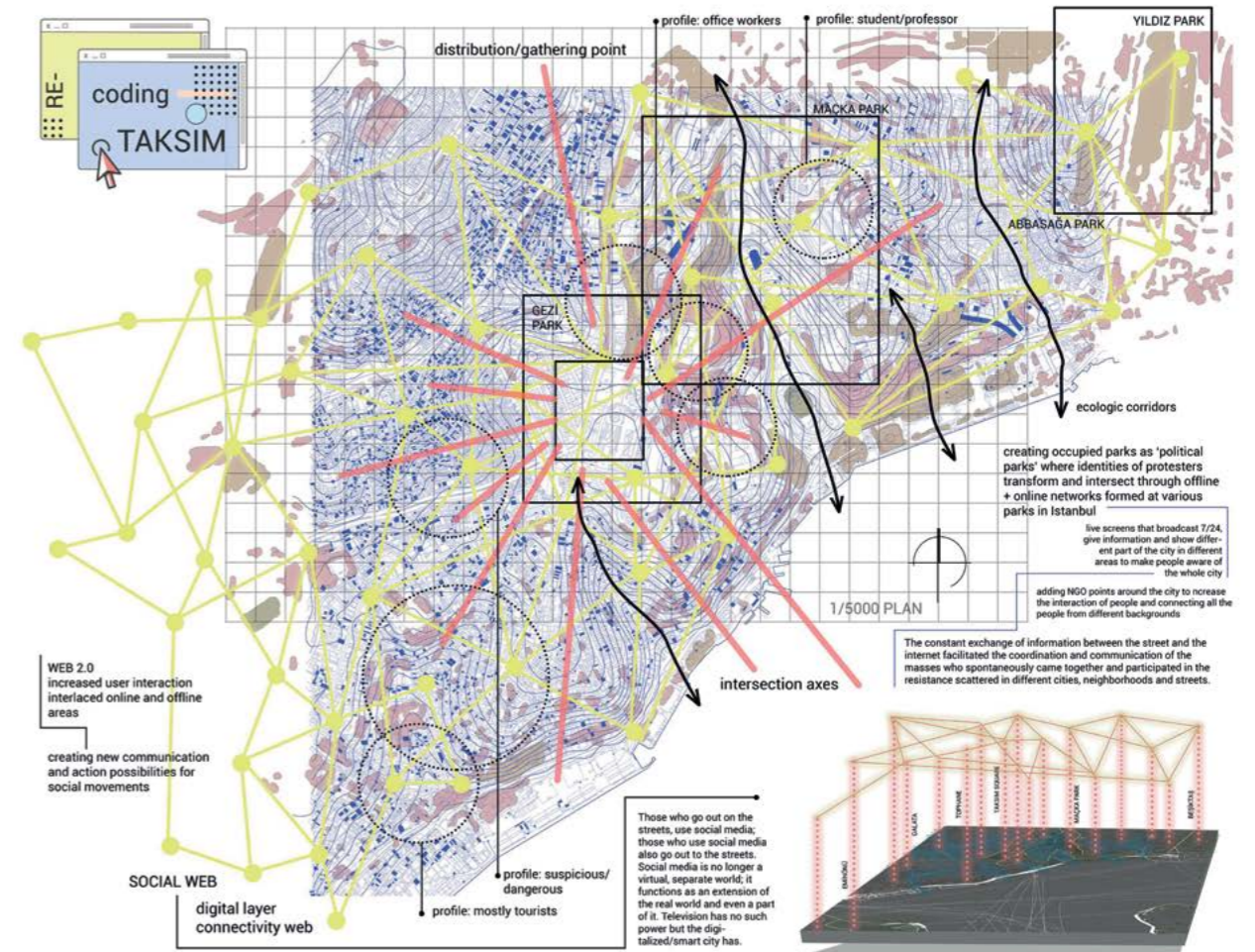
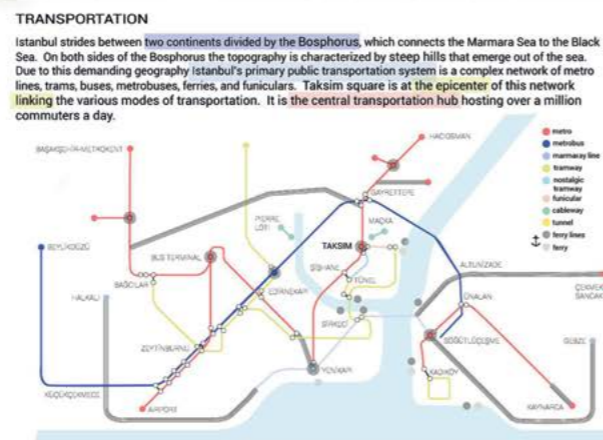
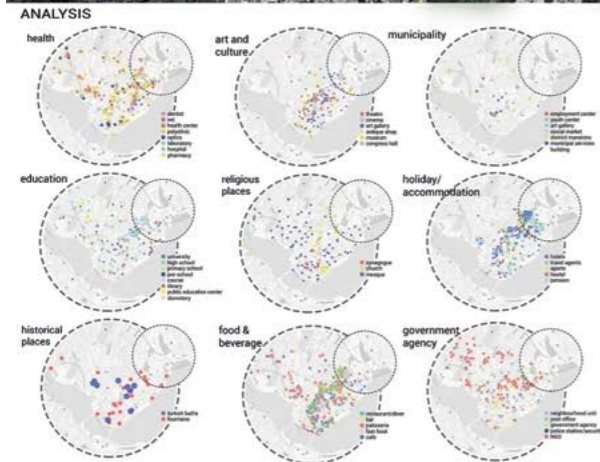

It has become a transition point where people do not enjoy spending time but escape from the crowd and lose each other. Thanks to the planned digital layer, we can now go digitally to Taksim, which we cannot go to comfortably even if we want to. At least our thoughts can go even if we cannot physically go. In short, as physical space; by creating an equal and free environment, it is aimed to create an atmosphere where people can make their words heard or show, and remember history and experiences. Digitally also it is aimed that people from Istanbul, Turkey, even people from all over the world can come to the square, actually not physically but digitally, share their thoughts and interact with each other in this digital place of freedom. The project was developed for a binding and unifying purpose in every aspect.

It was aimed to create a space where various people from different places and backgrounds, regardless of geography, religion, language, race, gender, age, gather at one point and establish bonds. Besides the digital connection, it was aimed to strengthen the ecological and spatially fragmented patches by combining them. With these strengthening green areas, spaces and functions, it was also aimed to increase and strengthen human connections over time. The connection of the area with the surrounding regions has been strengthened and functions have been added to the connection points, making it more attractive and useful. Green textures such as Gezi Park and Maçka Park, which are close to each other, have been combined and connected at the upper scale.





- LEGEND**
- pedestrianized area
  - ..... cycle path
  - heat pump pipe route
  - 1 memory museum + temporary pavillion
  - 2 graffiti/street art walls
  - 3 Taksim Garden
  - 4 light installations
  - 5 cafe
  - 6 green amphi-terraces
  - 7 exhibition panels ( digital/printed) used as open air cinema
  - 8 cooperative shop stands
  - 9 open-air workshops area + Taksim Solidarity point
  - 10 forum
  - 11 monuments
  - 12 open-air library
  - 13 workshops/exhibitions (water based)
  - 14 drawing wall - leave a trace!
  - 15 elevated/illuminated platforms
  - 16 historical screens (digital panels)
  - 17 digital screens
  - 18 meadow
  - 19 traces of the barrack
  - 20 memory lane (sculpture path)
  - 21 performance area /stage
  - 22 community garden ( bostan) + smell garden
  - 23 social hubs
  - 24 inreactive sculpture garden
  - 🚌 bus stop
  - 🚲 bike
  - 🚲 bike stop
  - 📶 wifi zones
  - 🚇 metro
  - 🚡 funicular
  - 🚕 taxi
  - 🚊 nostalgic tramway

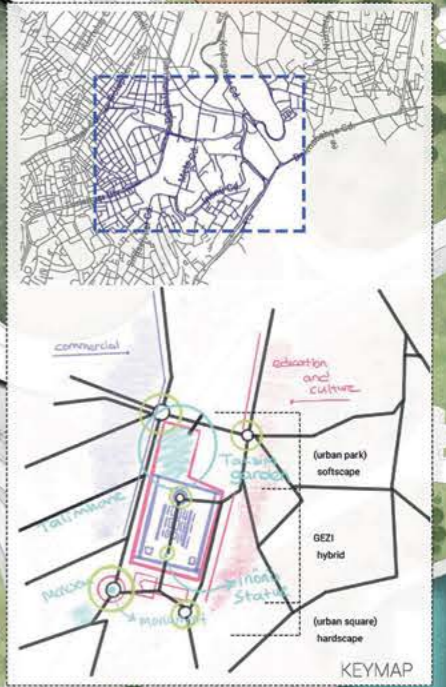

1/1000 PLAN





It was aimed to bring more students and young people together by creating an education and cultural route between Taşkılla, Atatürk Library and İTÜ Gümüşsuyu campuses. At the same time, special colors are determined according to the potentials of the area and the purpose of the design. For example, purple mostly represents cultural activities, roads and spaces, while pink represents social, interaction, communication and free thinking, yellow represents production in general, and green acts as the binding element between them.

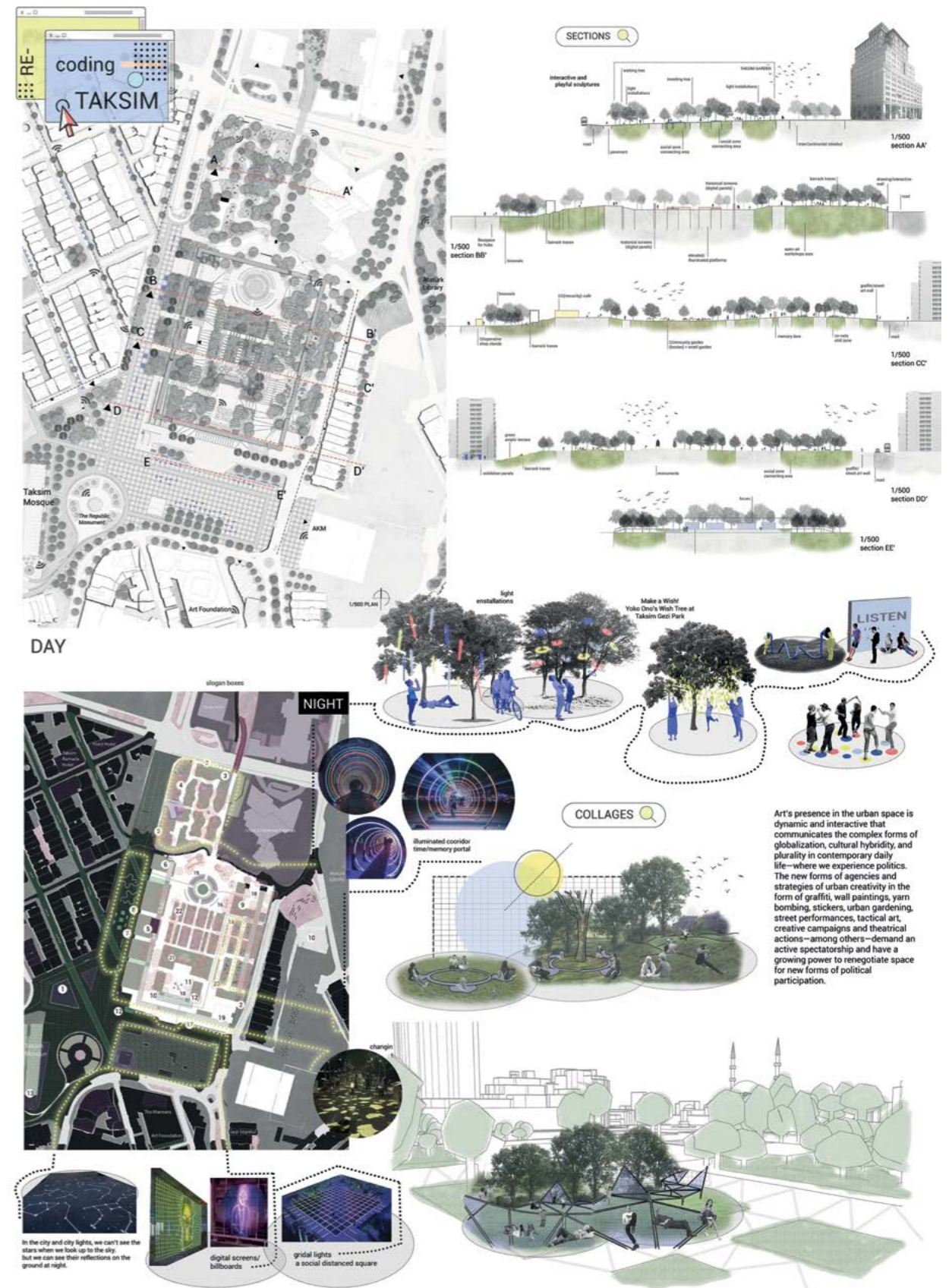

The walking process has been made more attractive for users by adding interactive digital panels compatible with digital devices on some of the main routes. In this way, walking people will be able to follow the news, then continue to watch them on their phones, create their artworks/graffiti in digital forms and leave their traces on the digital layer of the area.



At the same time, they will be able to take care of the plants they see as they pass by each day, water them and contact with nature a little between these huge concrete masses. While the Gezi Park was being designed, add-ons that are also connected to the digital were created, that is reminding the existence of various extinct things in the area. It is aimed that people can re-experience the history of the place as they travel around the space, experience an atmosphere where the past and present are connected, and thus revitalize the collective memory, or at least make it feel. To remind the past and to revive the destroyed barracks, the ruins of the barracks were reconstructed symbolically as a frame and a cover. The area where people used to spend time as Taksim Garden was redesigned with natural lines and the garden that used to be there was brought back to the present day. The existing trees in the park were preserved and those of historical significance were highlighted by light installations.

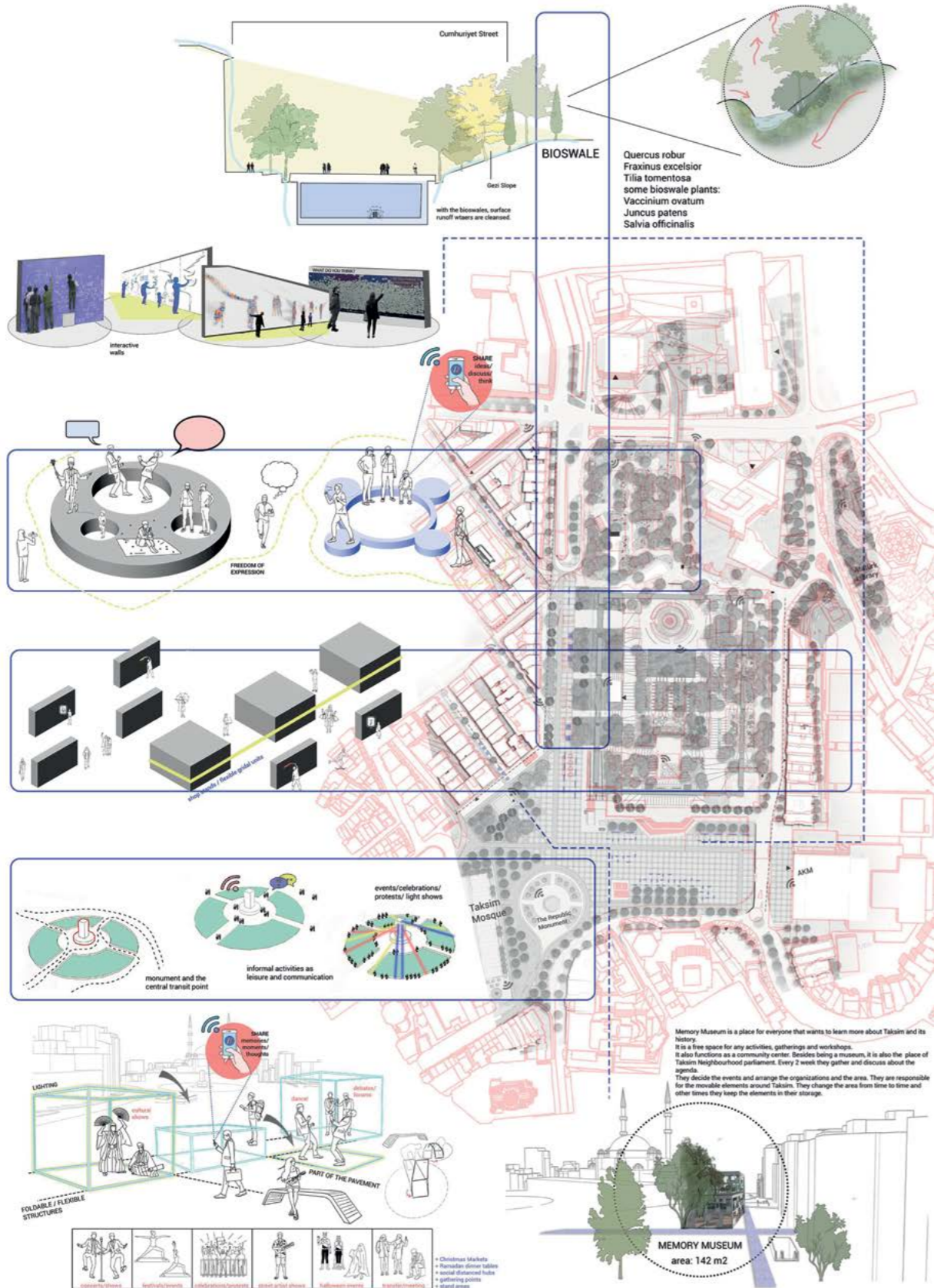

The bostans and gardens, which were also considered in the Istanbul Master Plan prepared by Prost, were added to the park as a community garden and a smell/butterfly garden. More edible and aromatic plants were preferred in the gardens and it was aimed to make it more rememberable, attractive and dynamic for people by creating smell gardens for the memory route. At the same time, attention was paid to the seasonal color changes of the plants. For different spaces, colors also vary according to the functions of the spaces. Also, it is aimed to sell the products produced in the bostans in the cafe and sales areas in the area. Additions have been made to develop graffiti and art in the city and in the field. New activities and functions were proposed to replace the unpleasant, badly remembered events in the venue.

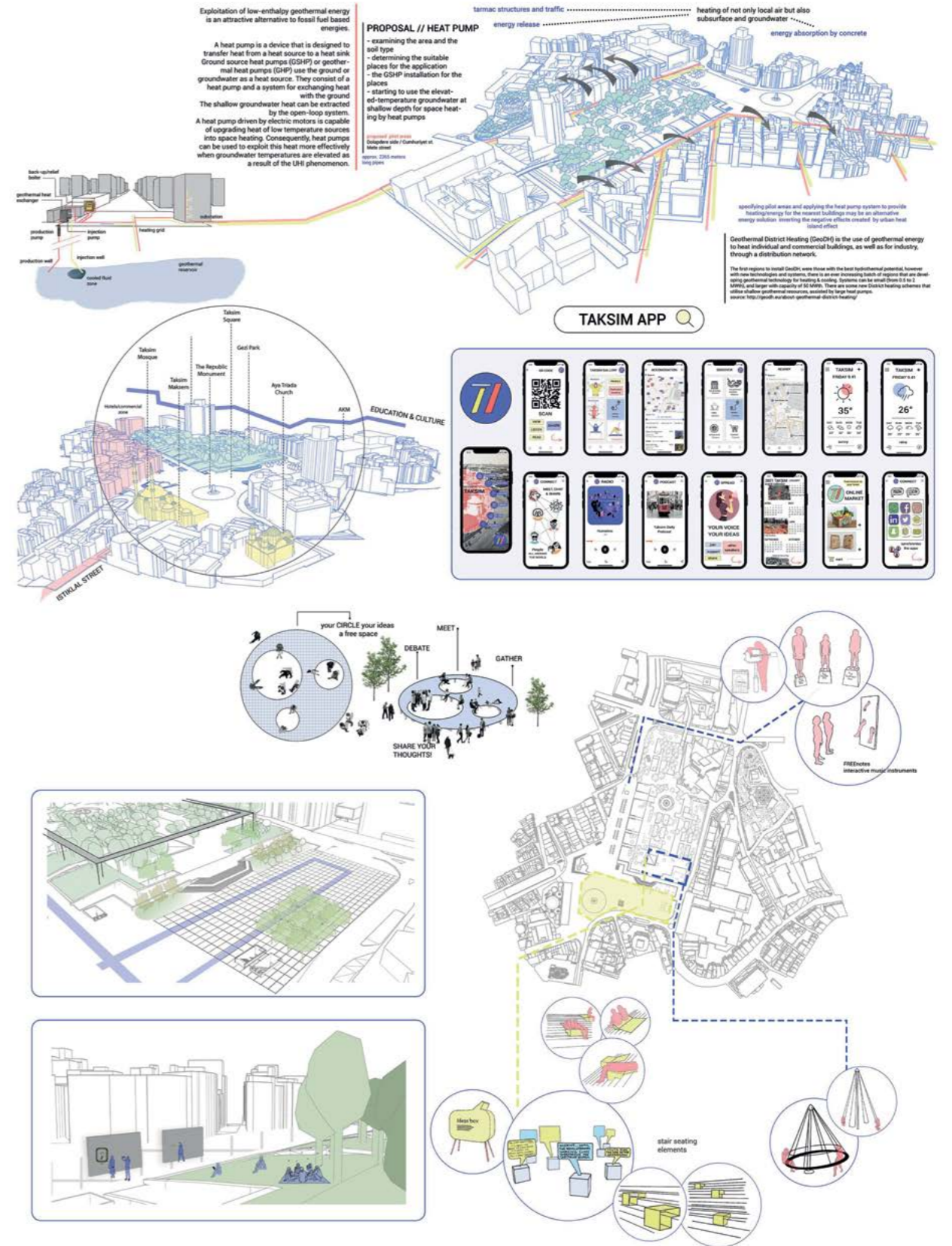





It is aimed to transform and update these unpleasant memories with new, good memories. Many interactive design elements have been added to the area. In addition, a digital application belonging to Taksim has been developed for those who use the area or just want to be a part of the space digitally. Thanks to the application, a free expression space has been created where they can listen to podcasts about Taksim, the latest news, past / present and future, share photos / memories from the area, communicate with many people and discuss their ideas. The spaces in the park are also designed as forum, free thinking and discussion areas, and urban furniture has been added. Movable seating elements and special gridal areas to be used for different events such as concerts/ shows/celebrations were determined in the square design. Foldable structures make the square more flexible and adaptable to events. The structures can be removed at the end of the event, turned back into a part of the pavement and stored. It is aimed that these flexible structures can be removed and used in the whole area when necessary. The memory museum in the area was also planned as a storage, public assembly, meeting, planning and consultation area. To reduce the heat island effect, vegetation was made, green areas were increased and bioswale areas were added.

The old plans, past and experiences of the area in general have been examined and inspired by them and their changes, places, routes and functions have been shaped. Thanks to the lighting designs, the area has become dynamic and alive in both day and night scenarios. It is aimed to integrate the past, present and future with the digital layer. Taksim, which needs a new update, had to be digitized and the ties that reconnected the past and the future had to be established and strengthened. In line with these inferences, a new design update was developed and implemented.

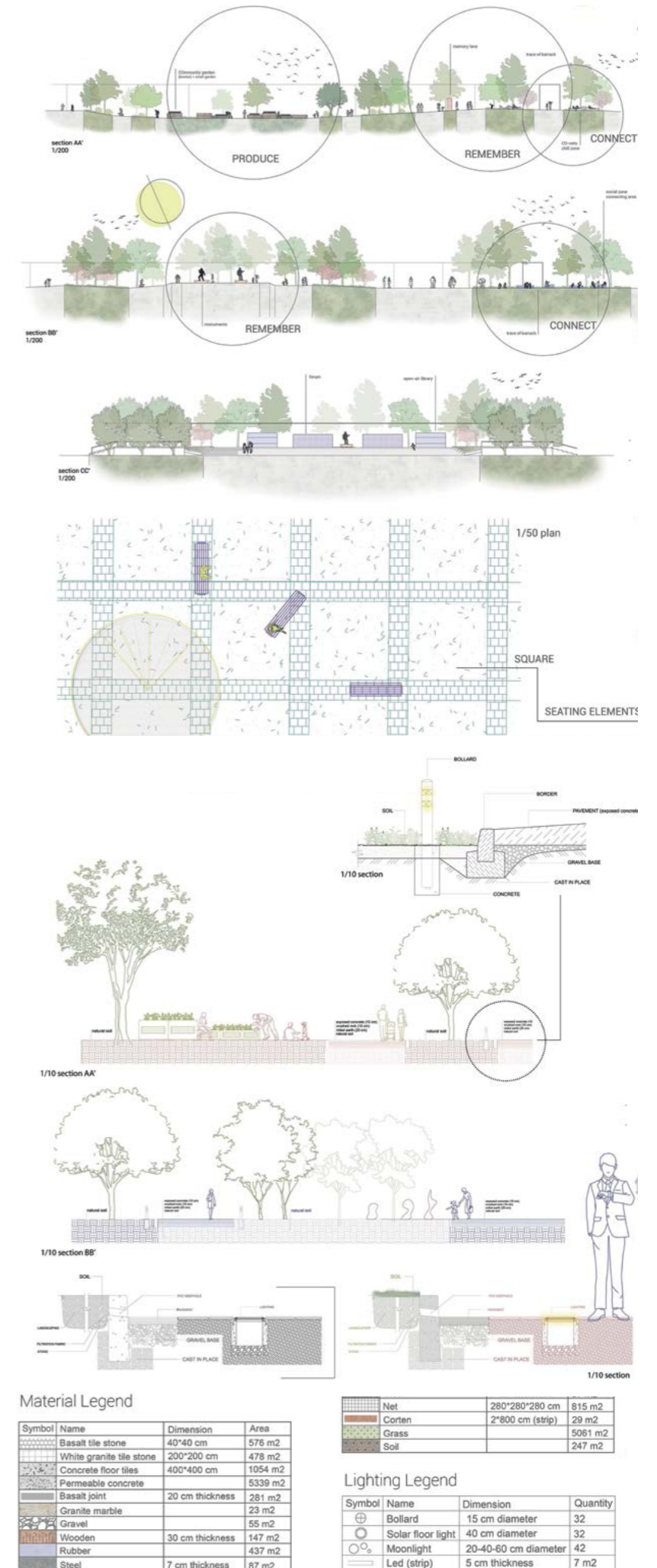

**Material Legend**

Symbol	Name	Dimension	Area
Basalt tile stone	40*40 cm	576 m <sup>2</sup>	
White granite tile stone	200*200 cm	478 m <sup>2</sup>	
Concrete floor tiles	400*400 cm	1054 m <sup>2</sup>	
Permeable concrete		5339 m <sup>2</sup>	
Basalt joint	20 cm thickness	281 m <sup>2</sup>	
Granite marble		23 m <sup>2</sup>	
Gravel		55 m <sup>2</sup>	
Wooden	30 cm thickness	147 m <sup>2</sup>	
Rubber		437 m <sup>2</sup>	
Steel	7 cm thickness	87 m <sup>2</sup>	

**Lighting Legend**

Symbol	Name	Dimension	Quantity
⊕	Bollard	15 cm diameter	32
⊙	Solar floor light	40 cm diameter	32
○	Moonlight	20-40-60 cm diameter	42
—	Led (strip)	5 cm thickness	7 m <sup>2</sup>





Seasonal color changes

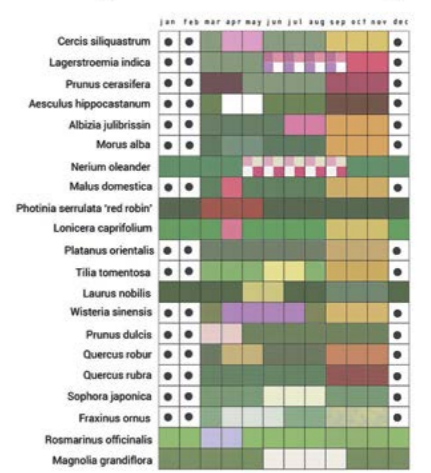

butterfly/smell gardens

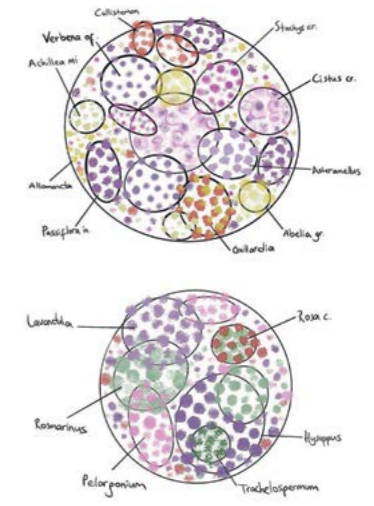
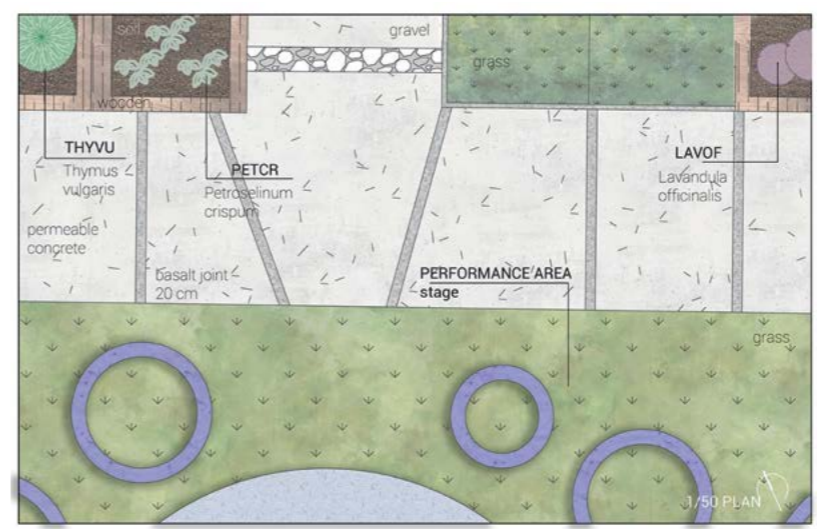

Evergreen Trees

Symbol	Abbreviation	Name	Height	Width	Trunk diameter	Trunk height	Unit	Quantity	Note
⊙	CUPSE	Cupressus sempervirens	20 m	2 m	18-20 cm	-	piece	10	Planting will be done according to the plan in the project.
⊙	CITLI	Citrus limon	6 m	2-3 m	25-30 cm	2 m	piece	7	Planting will be done according to the plan in the project.
⊙	LAUNO	Laurus nobilis	7 m	5 m	12-14 cm	1 m	piece	8	Planting will be done according to the plan in the project.

Deciduous Trees

Symbol	Abbreviation	Name	Height	Width	Trunk diameter	Trunk height	Unit	Quantity	Note
⊙	MALSY	Malus domestica	4 m	5 m	20-25 cm	1 m	piece	4	Planting will be done according to the plan in the project.
⊙	TILTO	Tilia tomentosa	25 m	12 m	50-100 cm	1 m	piece	11	Planting will be done according to the plan in the project.
⊙	LAGIN	Lagerstroemia indica	6 m	3 m	10-12 cm	3 m	piece	14	Planting will be done according to the plan in the project.
⊙	POPAL	Populus alba	20 m	7 m	35-40 cm	4 m	piece	7	Planting will be done according to the plan in the project.
⊙	ALBJU	Albizia julibrissin	8-10 m	6 m	20-25 cm	2 m	piece	2	Planting will be done according to the plan in the project.
⊙	PLAOR	Platanus orientalis	25 m	7 m	35-40 cm	3 m	piece	6	Planting will be done according to the plan in the project.

Shrubs

Symbol	Abbreviation	Name	Height	Width	Unit	Quantity	Note
⊙	FORIN	Forsythia x intermedia	2 m	2-3 m	piece	7	Planting will be done according to the plan in the project.
⊙	PELGR	Pterogonum graveolens	0.5-1.5 m	1 m	piece	3	Planting will be done according to the plan in the project.
⊙	SYRVU	Syringia vulgaris L.	3 m	2-3 m	piece	25	Planting will be done according to the plan in the project.
⊙	ASTAM	Aster amellus	0.2 m	1-2 m	piece	26	Planting will be done according to the plan in the project.
⊙	SPAJU	Spartium junceum	1.5 m	2 m	piece	20	Planting will be done according to the plan in the project.
⊙	ROSOF	Rosmarinus officinalis	1 m	2 m	piece	12	Planting will be done according to the plan in the project.
⊙	THYVU	Thymus vulgaris	0.2 m	1-2 m	piece	15	Planting will be done according to the plan in the project.
⊙	ROSCA	Rosa canina L.	1.5 m	2-3 m	piece	4	Planting will be done according to the plan in the project.
⊙	LAVOF	Lavandula officinalis	1-2 m	1 m	piece	33	Planting will be done according to the plan in the project.
⊙	CUCSA	Cucumis sativus	0.5 m	2 m	piece	6	Planting will be done according to the plan in the project.
⊙	ZEAMA	Zea mays	1.5-2.5 m	50-80 cm	piece	8	Planting will be done according to the plan in the project.
⊙	TRAJA	Tradescantia virginiana	0.6-6 m	50-80 cm	piece	28	Planting will be done according to the plan in the project.
⊙	PASIN	Passiflora incarnata	0.3 m	2-4 m	piece	10	Planting will be done according to the plan in the project.
⊙	VEROF	Verbena officinalis	1.5-3 m	3 m	piece	6	Planting will be done according to the plan in the project.
⊙	GAJAR	Gaillardia aristata	1.5 m	2 m	piece	3	Planting will be done according to the plan in the project.
⊙	PETCR	Petroselinum crispum	0.3-1 m	10-30 cm	piece	35	Planting will be done according to the plan in the project.
⊙	ALLCA	Allamanda cathartica	1 m	2 m	piece	7	Planting will be done according to the plan in the project.

Groundcovers

Symbol	Abbreviation	Name	Height	Unit	Quantity
⊙	CERTO	Cerastium tomentosum	20-30 cm	m2	82 m2
⊙	ERIDA	Erica darleyensis	20-25 cm	m2	1153 m2
⊙	LAMRO	Lampranthus roseus	10-15 cm	m2	256 m2
⊙	SALOF	Salvia officinalis	60-80 cm	m2	1316 m2
⊙	ROSDA	Rosa x damascena	100 cm	m2	266 m2
⊙	STACR	Stachys cretica	60 cm	m2	433 m2
⊙	LINUS	Linum usitatissimum	15-60 cm	m2	380 m2
⊙	ASPLI	Asperula littoralis	10-15 cm	m2	168 m2
⊙	OCIBA	Ocimum basilicum	0.3-0.5 m	m2	283 m2
⊙	HYSO	Hyssopus officinalis	60 cm	m2	92 m2
⊙	FERCO	Ferulago confusa	80-100 cm	m2	155 m2
⊙	ORIMA	Origanum majorana	60 cm	m2	178 m2
⊙	CHEAL	Chenopodium album	50-80 cm	m2	235 m2
⊙	MELOF	Melissa officinalis L.	40-50 cm	m2	84 m2

Climbers

Symbol	Abbreviation	Name	Height	Width	Unit	Quantity
⊙	WISSI	Wisteria sinensis	20 m	20-30 cm	m2	242 m2

Plant Legend

- aromatic plants
- boston plants
- butterfly/smell garden plants